

TECHNICAL DATA SHEET

BRISTAN

PISA

Basin Taps

Product Specification

Product Code:	PS ½ C
Finish:	Chrome plated
Product Type:	Contemporary
Construction:	Bodies are of all brass construction and designed to conform to BS EN 200
Valve Type:	1/2" ceramic disc valve ½ turn
Supply:	Suitable for all plumbing systems
Inlet Connections:	½ " BSP threaded tail
Working Pressures:	Min 0.2 Bar Max 7.0 Bar



Additional Information

- Supplied with metal backnuts.
- Supplied with metal handles.
- Chrome plated to BS EN 248.

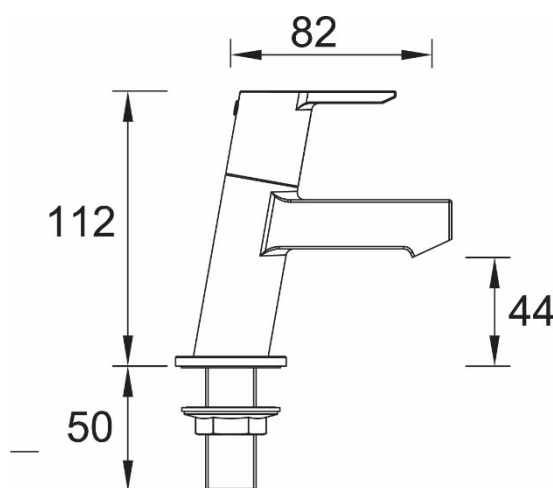

Flow Rates (litres per minute)

System Pressure	0.2bar	0.5bar	1.0 bar	2.0 bar	3.0bar	5.0bar
PS ½ C (Hot)	7.34	11.64	15.74	22.73	28.04	35.78
PS ½ C (Cold)	7.41	11.72	15.82	22.98	28.34	36.21

Compliance / Approvals

WRAS Approval No: 1107100

Technical Advice: For further information please call 0844 7016273 or email customercare@bristan.com.

Guarantee: 5 years covering manufacturing faults.

Bristan, Birch Coppice Business Park, Dordon, Tamworth, B78 1SG
Telephone: 0844 701 6274 Facsimile: 0844 701 6275
Web Site: www.bristan.com Email: enquire@bristan.com

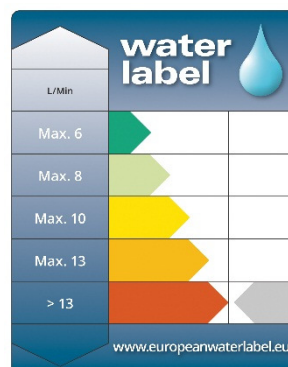

The information contained on this page was correct at date of issue. Fitting dimensions are provided as a guide only. Some variation may occur due to manufacturing tolerances. Bristan pursues a policy of continuing improvement in design and performance of its products and so reserves the right to change specifications without prior notice.