

AFTERCARE INSTRUCTIONS

Your fitting has a high quality finish and should be treated with care to preserve the visible surfaces.

All surface finishes will wear if not cleaned correctly, the only safe way to clean your mixer is to wipe with a soft damp cloth. Stains can be removed using washing up liquid. All bath cleaning powders and liquids will damage the surface of your fitting, even the non-scratch cleaners. **NOTE: Never use abrasive detergents or disinfectants or those containing alcohol, hydrochloric acid or phosphoric acid.**

Bristan recommend E-Cloth for cleaning all of our bathroom & kitchen products. Using just water, E-cloth gives a smear free, deep clean by breaking up and holding dirt, which normal cloths leave behind. Order through your Bristan stockist. (ORDER CODE: ECLOTH)



GUARANTEE

All products are manufactured to the highest standards and a 5 year guarantee covers any defect in manufacture.

NOTE: The 5-year guarantee on the cartridge is invalidated if damaged by any waterborne debris.

All products must have access for servicing or replacement during the life of the product.

In the interests of continuous product development we reserve the right to alter specification as necessary

PRODUCT CODE:

PRODUCT IDENTIFICATION CODE LASER ETCHED ON PRODUCT
Installer please fill in code here _____.(Where applicable)

TELEPHONE HELPLINE! +44 (0)844 701 6273

Bristan Group Limited
Birch Coppice Business Park
Dordon
Tamworth
Staffordshire
B78 1SG
UK

A Masco Company
Website: www.bristan.com
Telephone: +44 (0) 844 701 6274
Facsimile: +44 (0) 844 701 6275

(FI PM WMBF)

(REV D5)

BRISTAN

Prism Wall Mounted Bath Filler

Fitting Instructions & Contents List

Before starting any installation project please consider:

Prior to drilling into walls, check there are no hidden electrical wires, cables or water supply pipes with the aid of an electronic detector. If you use power tools do not forget:



- Wear eye protection
- Unplug equipment after use

Please keep these instructions for future reference and request of replacement part

WATER PRESSURE

This mixer is suitable for use at all supply pressures. (Minimum 1.0 bar). For optimum use both the hot and cold supplies should be reasonably balanced.

This mixer should be installed in compliance with the Water Regulations. Where the supplies are unbalanced, i.e. hot water from cylinder tank / cold from the mains, approved check valves must be fitted in the supply pipes.

For further details contact your Local Water Authority.

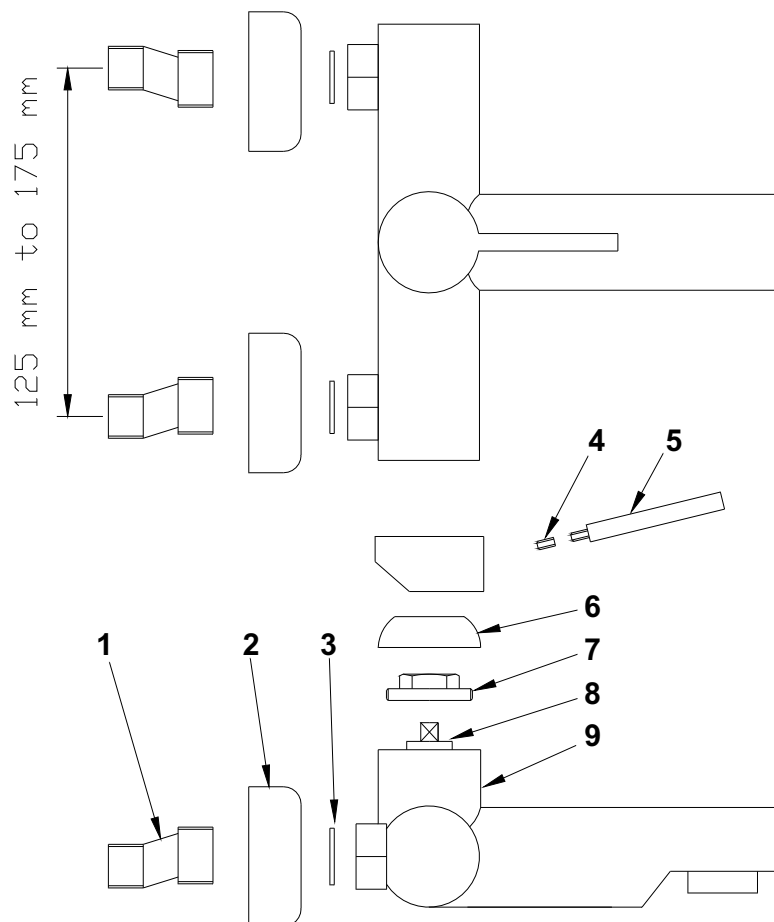

CONTENTS

1. Cranked Connectors	(x2)
2. Flange Covers	(x2)
3. Large Washers	(x2)
4. Grub Screw	(x2)
5. Head Lever	(x1)
6. Shroud	(x1)
7. Retaining Nut	(x1)
8. Cartridge	(x1)
9. Mixer Body	(x1)

INSTALLATION

1. Identify all components and check for completeness, particularly before arranging installation.
2. Fit and seal the cranked connectors (1) into the wall connections, ½" BSP female (not provided).
3. Fit the flange covers (2) and mixer body (9) to the cranked connectors (1) using the large sealing washers (3) and connect the hot and cold water supplies.
4. Fully open the mixer in mid position, letting it run to check all joints and connections for leaks.
5. See over the page for aftercare instructions.

NOTE: As there are no backnut or fixing plates supplied, the bath filler needs to be Connected/supported with rigid pipe work.

MAINTENANCE

If the fitting begins to drip:

1. Turn off the water supply
2. Unscrew handle lever (5), loosen grub screw (4) with 2.5mm hexagonal key and pull off head.
3. Unscrew retaining nut (7) and remove cartridge (8).
4. Carefully clean seating, rubber washer and ceramic disc. **Note: That there are locating pins on the bottom of the cartridge that fit in holes inside the tap, To ensure it is fitted the right way round.**
5. Replace the cartridge and head then turn on the water supply.
6. Contact our helpline if problem persists.

PLEASE NOTE:

In the unlikely event you find a part missing, please contact our Customer Service helpline on **0844 701 6273** for immediate dispatch of part