

# Installation Instructions

Two-Part Bath Screen  
With & Without Towel Bar

# Installation Instructions

## Positioning

- 1.1 Distance A = Wall to inside edge of bath.

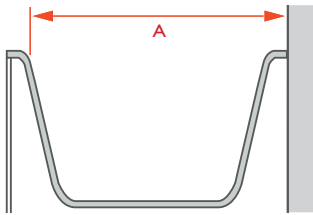

- 1.2 Distance B (screen profile) = Distance A + 10mm

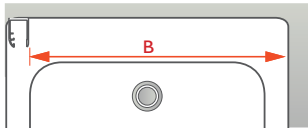

- NB** Screen must be set 10mm in from the bath edge in order for rubber seal to be water tight.

## Fixing Rail

- 2.1 Place fixing rail against wall in correct position, mark drill points, then remove and drill holes for 8mm wall plugs.  
Note: Please ensure the rail is plumb.

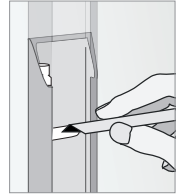

- 2.2 Apply an even covering of a silicone based sealant to the back of the fixing rail prior to fixing.

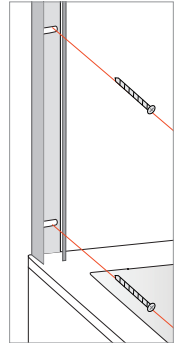

- 2.3 Fix the fixing rail to the wall with the screws provided.

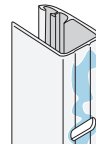

## Positioning Screen

- 3.1 Position first section of screen into the fixing rail (approx. 25mm variation is possible here) ensuring that the seal is in place at the bottom of the glass.

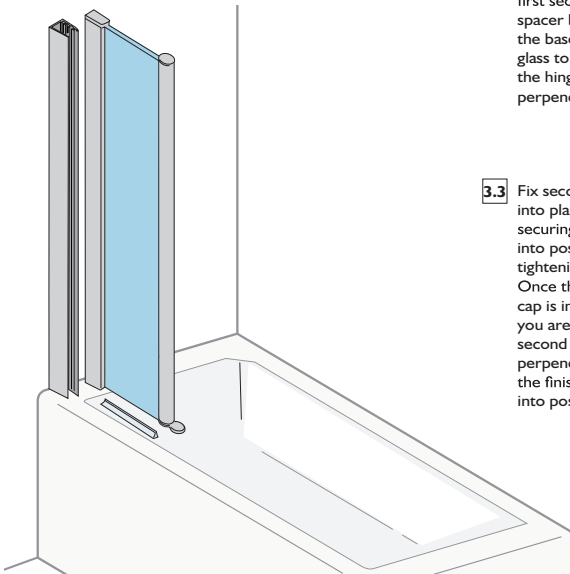

- 3.2 Place second section of screen onto the bottom hinge of the first section with spacer block along the base of the glass to ensure that the hinge remains perpendicular.

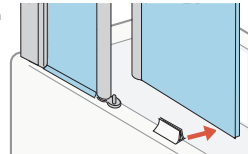

- 3.3 Fix second section into place by securing fixing cap into position and tightening screw. Once the fixing cap is in place and you are sure the second section is perpendicular put the finishing caps into position.

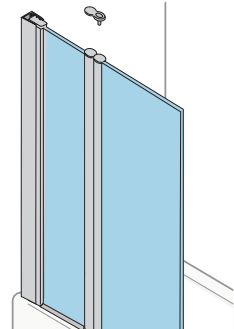

## Fixing Screen

- 4.1 Once in position, drill pilot using a 2.75mm dia. drill.

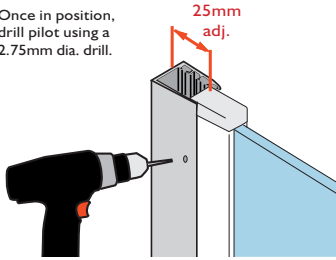

- 4.2 Next, fit the screen to the fixing rail using the self tapping screws and covers.

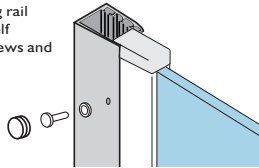

- 4.3 Remove the positioning block and replace with the rubber seal. Use just one of the chrome end caps to the outer of the seal strip.

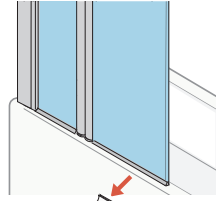

- 4.4 To improve security of screen, fit wall bracket to the screen with fixing screw provided and then to the wall, ensuring that buffer pads are placed between the wall bracket and glass.

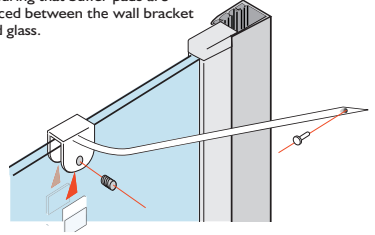

## Sealing Screen

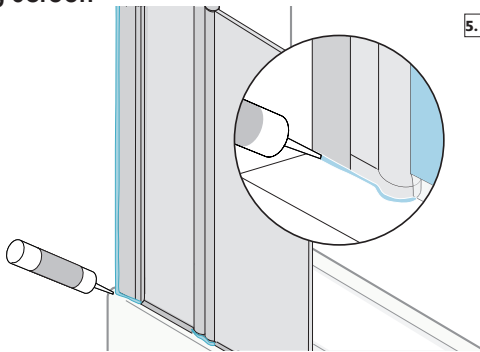

- 5.1 Using a silicone based sealer (always check product instructions to check if suitable), seal along the outside edge of the vertical fixing rail and the wall, as well as between the outside bottom of the screen frame (including pivot hinge section) and the bath.

CORRECT



INCORRECT

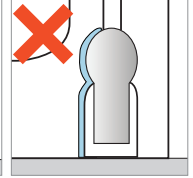

## Fixing Towel Rail (optional)

- 6.1 If your screen comes with the optional towel bar then simply assemble the components as illustrated here and secure with Allen key provided.

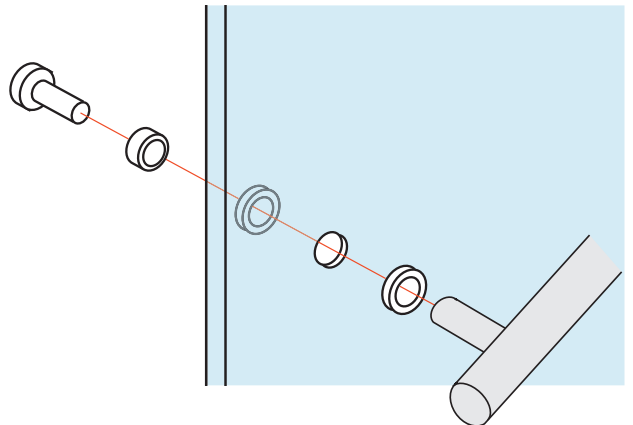

Due to our commitment to continuous product development we reserve the right to alter specifications without notice. Products are guaranteed against manufacturing defects for the first purchaser only and the guarantee is non-transferable. Our liability under any guarantee expressed or implied is strictly limited to replacement of defective goods or a refund at our discretion and no consequential losses will be entertained. Proof of purchase will be required.