

Quick Start Guide

Note VENTILATION IS ESSENTIAL Read 'Step 2' 'Ventilation' before you start.

Note This quick start guide must be read in conjunction with the Installation instructions, User guide and Tap installation instructions, supplied with the tap.

- Before proceeding, read the installation Instructions and User guide.
- Check all the components are present and correct.
- Check that you have all the necessary tools.



- Ensure the under-counter cupboard floor can support the product weight when full of water, (check the specifications in the Installation instructions and allow an extra 5kg when full of water).

Prior to installation, ensure that the following have been provided at the installation site.

- Sufficient space in the cupboard to install the Command-Centre™ and its ancillary components. Refer to the Technical specification of the Installation instructions for dimensions. If required, make allowance for a booster, (refer to the Installation instructions for details).
- A potable water supply connection with min / max working pressures of: (refer to the Technical specification of the Installation instructions for specific model information).
- An isolating valve inside the cupboard within reach of the flexible braided hose and positioned so that the connection point and the stop cock will not be obstructed when the Command-Centre™ and its ancillary components are installed.
- For Zip HydroTap®G4, a single 220-240V AC, 13A socket is required. For Zip HydroTap®G4 + Booster, two 220-240V AC, 13A sockets are required. (One socket is for the Zip HydroTap®G4 and the other for the booster).
- Both the Command-Centre™ and booster must be installed in accordance with IEE regulations, See Technical specifications in the Installation instructions, for power ratings.

Note Check the cable lengths and outlet positions before proceeding and ensure that the tap location will allow the tap spout to drain into the sink.

- For the mains pressure All-in-One, both a hot and cold water supply is required.
- The Command-Centre™ and booster must be mounted in upright positions, with their base mounted horizontally, as shown overleaf.

IMPORTANT! Do not proceed with the installation if these requirements are not met.

Parts supplied	Description	Parts supplied	Description
	1 x HydroTap®G4* Classic, Elite or #Arc / Cube #(inc. Tube kit)		1 x User guide and 1 x Quick start guide 1 x Installation instruction
	1x All-in-One* HydroTap®G4 Mains or Vented		1 x Booster option inc. connection hoses.
	1 x Mixer tap* Classic, Arc or Cube		1 x Installation fittings (configuration supplied dependant upon tap model)
	1 x Command-Centre™ with air and water filters		1 x Mains water connection hose
	Vent kit 2 x Air outlet vent 1 x Air inlet vent		1 x CO2 gas cylinder assembly

* Tap options supplied are dependant upon configuration purchased.

Step 1- Prepare and install the taps. (For full detailed instructions of All-in-One & Arc / Cube HydroTaps and Arc / Cube mixer taps, see the Tap installation instructions supplied with the tap).

HydroTap®G4 Classic & Elite tap installation

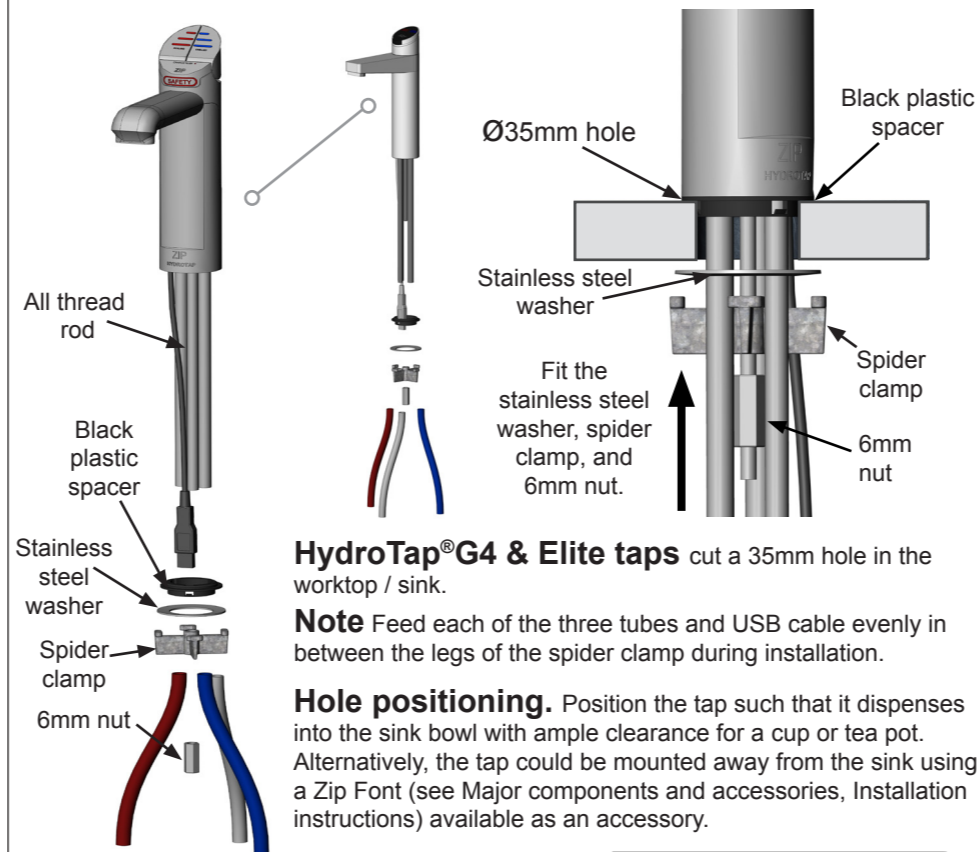

Apply a light smearing of silicon sealant on the underside of the spacer to ensure a watertight fit.

Mixer tap installation



Note The Classic mixer tap has a different installation to Arc / Cube mixer taps, see the Tap installation instructions supplied with the tap for full detailed instructions of all installation configurations.

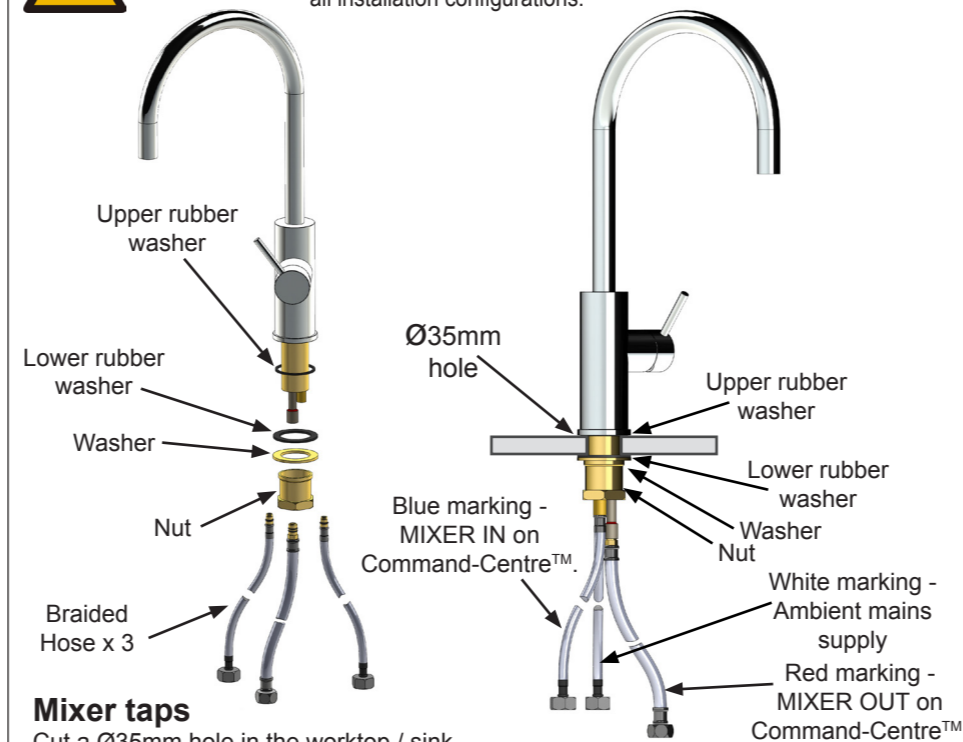

Step 2- Cut cupboard holes and fit the air vent ducts.

Ventilation

Ventilation for all models

- The clearance envelope dimensions stated in the Specification sheets and Installation instructions must be observed.
- Adequate ventilation must be provided to ensure that the cupboard space temperature does not exceed 35°C.

Preferred arrangement

4mm door buffers (at the four corners of each door) supplied with the Command-Centre™ should be used to provide adequate ventilation in normal usage, (as shown in the adjacent illustration).

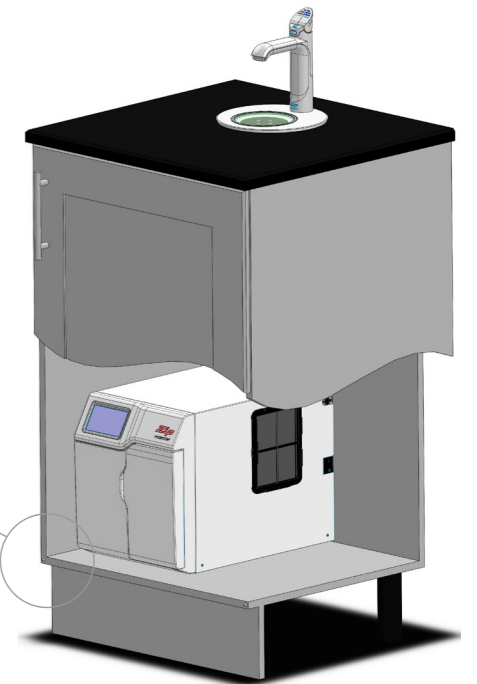
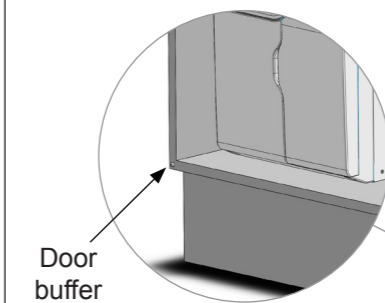

Alternative arrangement

- For applications where the cupboard space temperature is near 35°C or higher, the vent kit supplied must be used to provide ventilation by convection. See arrangement below for details.

Note The vent kit has to be installed in a way that allows air to be drawn in from the bottom of the cupboard and expelled through the top of the cupboard. The outlet vent should be towards the top of the door (position **A1**) or side of the cupboard (position **A2**). (Where possible air inlet vent and the air outlet vent should be positioned at opposite ends of the same cupboard space).

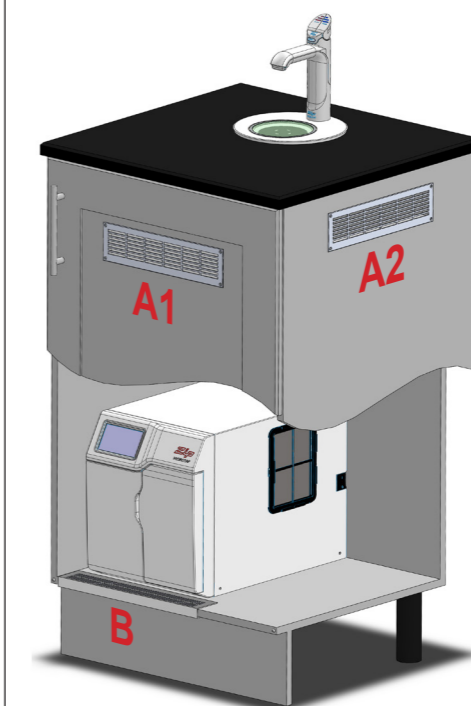

Vent cut-out details

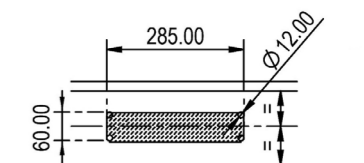

A1 or A2 Air outlet vent

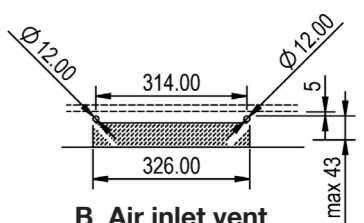

B Air inlet vent

Note Flat outlet vent detail shown above, louvred outlet vent also supplied.

Step 3 - Installing the booster (if required).

Booster system

Note 1 Water connection.
Blue cap - water in.
Red cap - water out.
The braided hoses cannot be lengthened.

Note 2 Position the booster according to the flexible hose and cable lengths supplied. Keep the booster as close as possible to the Command-Centre™ inlet / outlet fittings.

Note 3 Ensure the booster is mounted in an upright position (as shown) with a horizontal base.

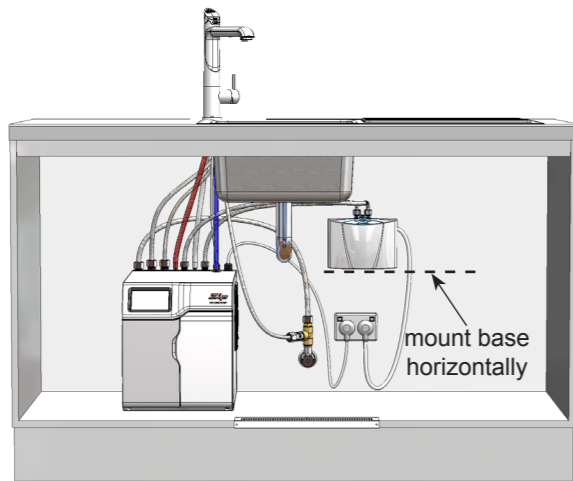

Remove the wall mounting chassis from the rear of the booster for wall mounting.

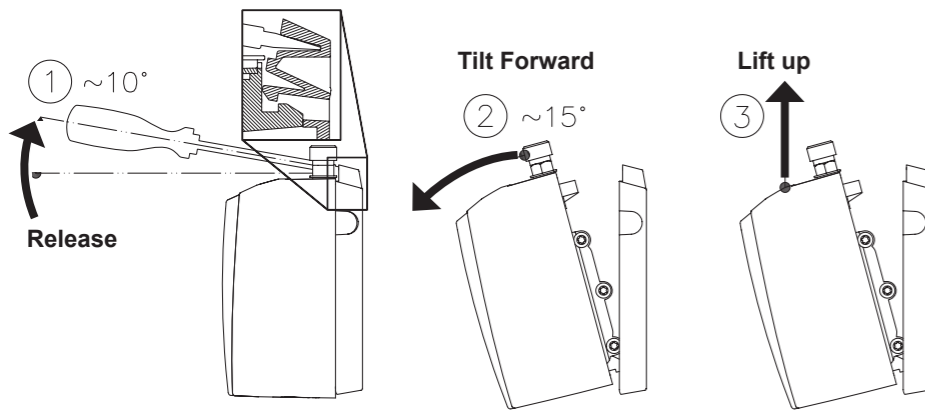

Booster installation

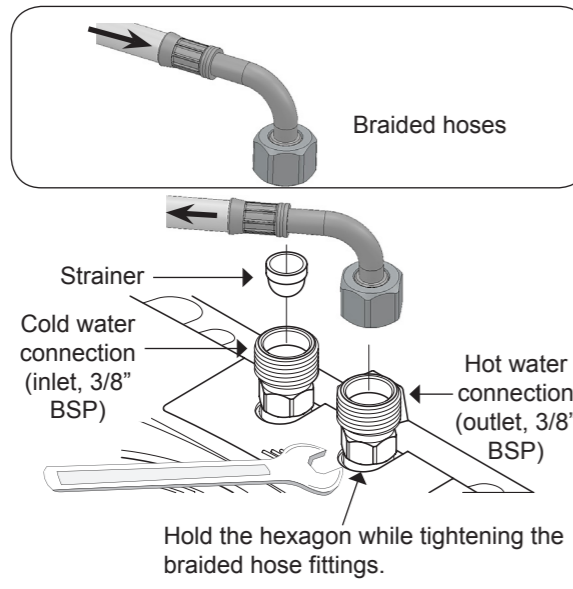
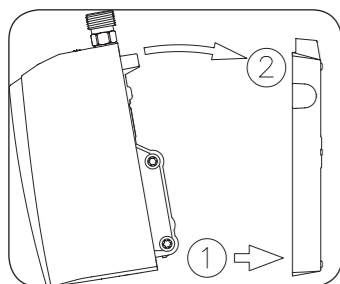
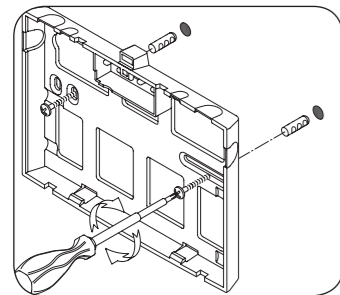

Step 4- Installing the Command-Centre™.

Command-Centre™ installation

Example HydroTap®G4 Classic model (For All-in-One and mixer tap models, refer to the Installation instructions).



Note For CO₂ cylinder installation refer to the CO₂ section of the Installation instructions.

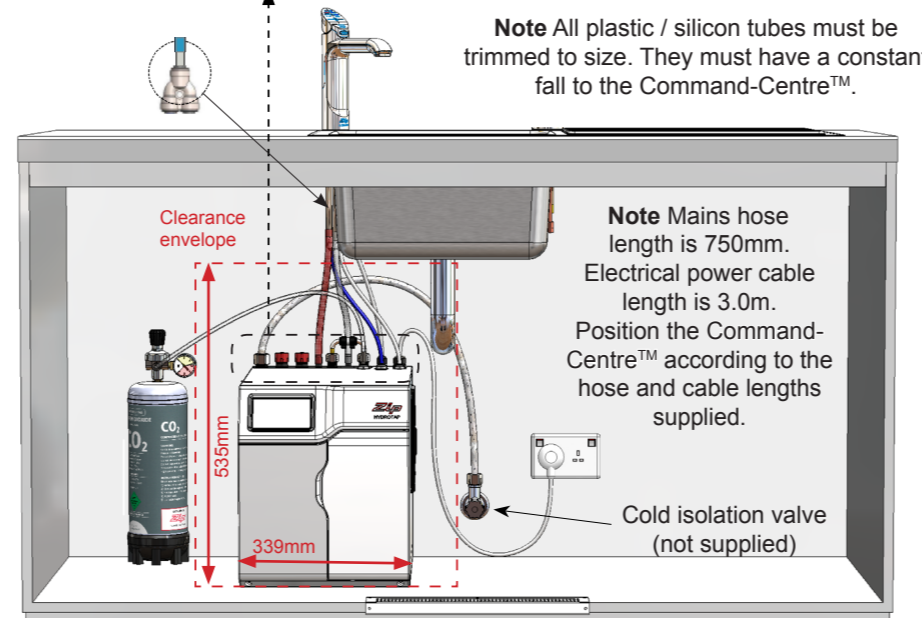
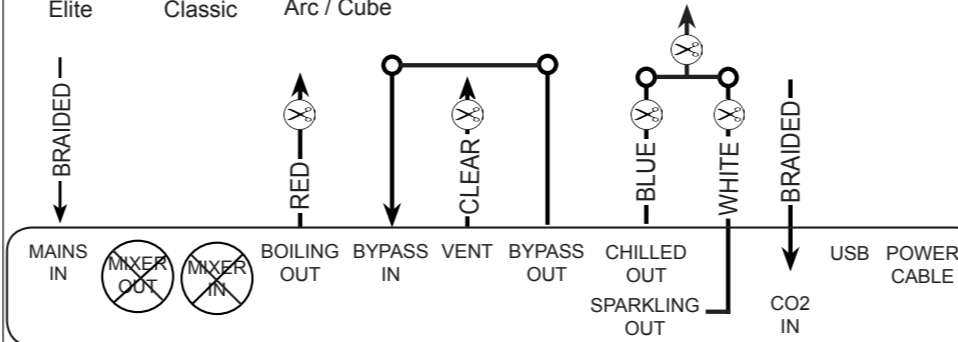

Step 5- Commissioning.

Commissioning

Safety sensor calibration

Light intensity varies from site to site, therefore it is recommended that a re-calibration be performed at the time of the installation. Refer to the Commissioning section of the Installation instructions for details.

Select the language

Press the [Language] button on the initial commissioning screen, then select either [English] or [Deutsch].

CO₂ Purge

- Press the [MENU] button for main menu.
- Press the [Install] button.
- Press the [Purge CO] button.
- In the next screen, press the [START] button to commence the purging process.

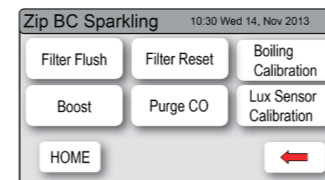

- You will hear the CO₂ gas running through the tap.
- Run for 10 seconds to fully purge the CO₂.
- Press the [STOP] button to stop the purge.
- Press [NEXT] for filter flush screen.

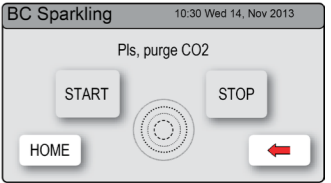

Filter flush and boiling calibration

Note At first commissioning, the system will select filter flush screen automatically.

Have a bucket or similar container (not supplied) at the ready to hold a quantity of water that will be ejected while the filter flush mode is in operation. Open the filter access door on the front of the Command-Centre™ and the filter cartridge will be exposed. Located to the rear right hand side of the cartridge is a flush line, approx 600mm long, and the flush line stop cock. Place the free end of the flush line into the bucket or container (not supplied).

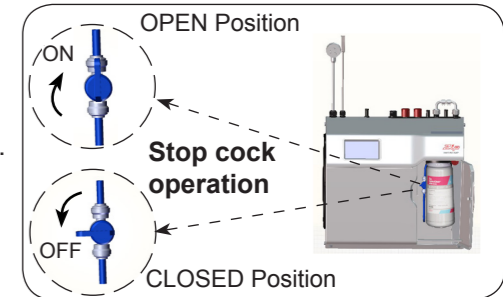

- Open the flush line stop cock.
- Press [START] button to start filter flush.
- Allow at least 10 litres of water to flush through the filter.
- Once the filter flush is finished, close the flush line stop cock, then press [STOP] to end filter flush mode.
- Press [NEXT] and the screen will display the flow calibration screen.
- Press the [START] button and the tank will first empty then fill. Upon completion the pulse count will be displayed. Check this reading is within the limits.
- Press [NEXT] for the boiling calibration screen.
- Press the [Calibrate] button and the system will commence the boiling calibration procedure. This will take approximately 5-6 minutes.
- Upon completion, a booster reminder screen will appear and allow you to return to the home screen by pressing the [HOME] button.
- Check the date and time settings, see section G of the user guide.

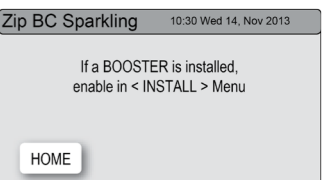
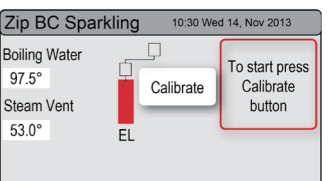

Boost enable/disable

To enable the booster (if fitted).

- Press the [MENU] button for main menu.
- Press the [Install] button.
- Press the [Boost] button.
- In the next screen, select [YES] to enable the booster.
- Water must be run through the booster for a minimum of 30 seconds, before the heater is activated.
- Dispense boiling water for 30 seconds and check the booster outlet hose is warm when the boiling water tank is replenishing.

