

# TECHNICAL DATA SHEET

## TAP REVIVERS

### Traditional Heads

### Product Specification

Product Codes:	R 1/2 TC (Basin Taps) R 3/4 TC (Bath Taps)
Finish:	Chrome
Product Type:	Contemporary
Valve Type:	1/2" or 3/4" Standard Valves
Supply:	Suitable for all plumbing systems



### Additional Information

- Includes a pair of handles and standard valves in order to refresh an old tap or repair a faulty tap
- 1/2" Reviver pack is suitable for use with most 1/2" 5412 and 1/2" 1010 taps
- 3/4" Reviver pack is suitable for use with most 1/2" 5412, 3/4" 5412 and 3/4" 1010 taps
- Pack also includes various spacers and washers for use in different configurations to meet various tap seating depths

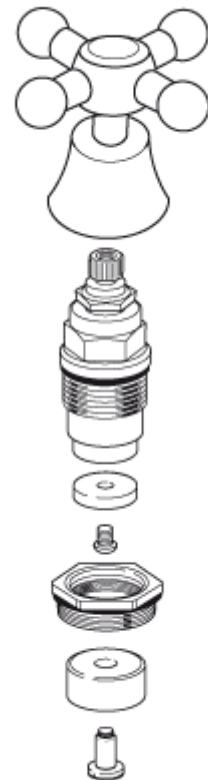

**Technical Advice:** For further information please call 0844 7016273  
or email [customercare@bristan.com](mailto:customercare@bristan.com)

**Guarantee:** 5 years covering manufacturing faults.