

Zeparo ZU



Automatic air vents and separators

Micro bubble, dirt, combined

*Engineering
GREAT Solutions*

Zeparo ZU

Comprehensive range of products for venting and separation of micro bubbles, sludge, oxygen and magnetite in heating, solar and cooling water systems. The diversity of the applications as well as their modular construction is unique. The helistill separator makes these products incredibly efficient.



Technical description

Application:

Heating, solar and chilled water systems.

Media:

Non-aggressive and non-toxic system media.

Addition of antifreeze agent up to 50%.

Pressure:

Max. admissible pressure, PS: 10 bar

Min. admissible pressure, PSmin: 0 bar

Temperature:

Max. admissible temperature, TS: 110 °C

Min. admissible temperature, TSmin: -10 °C

Zeparo ZUTS, ZUVS, ZUVLS solar:

Max. admissible temperature, TS: 160 °C

Min. admissible temperature, TSmin: -10 °C

Material:

Brass

Transportation and storage:

In frostless, dry places.

Diagram

Approx. pressure loss (Δp) – Separator

Zeparo ZUV, ZUVL, ZUD, ZUM, ZUML, ZUK, ZUKM, ZUC, ZUCM

DN 20-40

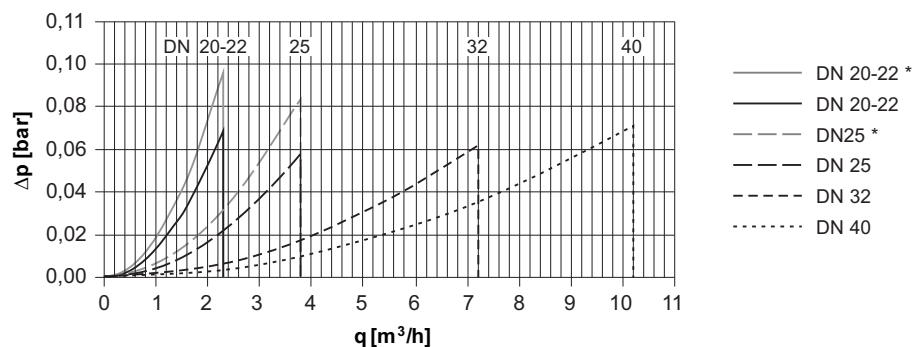

* = Lateral

Zeparo DN 20-40 must operate within the limits $\leq q_N$.

Zeparo ZUT – Automatic air vent, version Top

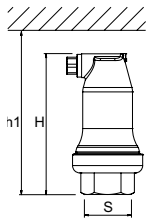

Zeparo ZUT

Female thread. Vertical installation.

Type	H	h1	m [kg]	S	dpu [bar]	EAN	Article No
ZUT 15	124	149	0,6	Rp1/2	10	7640148632454	789 0515
ZUT 20	124	149	0,7	Rp3/4	10	7640148632461	789 0520
ZUT 25	124	149	0,7	Rp1	10	7640148632478	789 0525

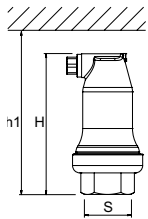

Zeparo ZUTS solar

Female thread. Vertical installation.

Type	H	h1	m [kg]	S	dpu [bar]	EAN	Article No
ZUTS 15	124	149	0,6	Rp1/2	10	7640148632492	789 1615

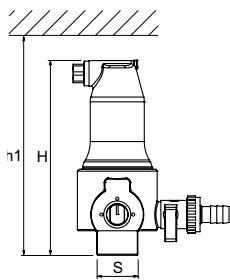

Zeparo ZUTX eXtra-lockable

Male thread. Vertical installation.

Type	H	h1	m [kg]	S	dpu [bar]	EAN	Article No
ZUTX 25	159	184	1,3	R1	10	7640148632485	789 1325

dpu = Working pressure range

Zeparo ZUP – Automatic air vent, version Purge

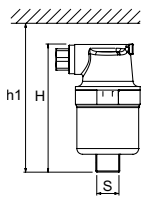

Zeparo ZUP

Male thread. Vertical installation.

Type	H	h1	m [kg]	S	dpu [bar]	EAN	Article No
ZUP 10	90	110	0,4	R3/8	6	7640148632508	789 1510

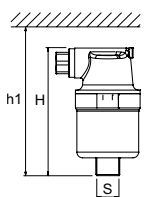

Zeparo ZUPW

Male thread. Vertical installation.
Color white.

Type	H	h1	m [kg]	S	dpu [bar]	EAN	Article No
ZUPW 10	90	110	0,4	R3/8	6	7640148632515	789 1410

dpu = Working pressure range

Zeparo ZUV – Separator, version Vent for micro bubbles

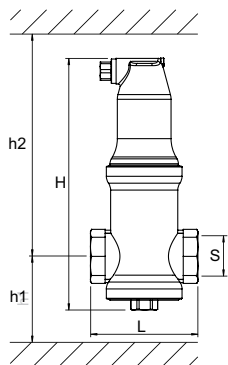

Zeparo ZUV

Female thread. Horizontal installation.

Type	H	h1	h2	L	m [kg]	S	qN [m ³ /h]	qN _{max} [m ³ /h]	EAN	Article No
ZUV 20	204	73	176	88	1,1	G3/4	1,3	2,3	7640148632522	789 1120
ZUV 25	207	64	188	88	1,2	G1	2,1	3,8	7640148632546	789 1125
ZUV 32	239	81	203	88	1,4	G1 1/4	3,7	7,2	7640148632553	789 1132
ZUV 40	273	83	235	88	1,5	G1 1/2	5	10,2	7640148632560	789 1140

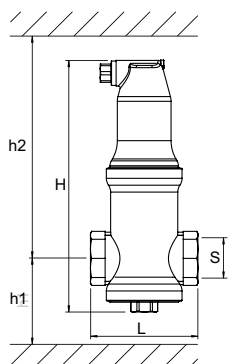

Zeparo ZUVS solar

Female thread. Horizontal installation.

Type	H	h1	h2	L	m [kg]	S	qN [m ³ /h]	qN _{max} [m ³ /h]	EAN	Article No
ZUVS 20	204	73	176	88	1,1	G3/4	1,3	2,3	7640148632607	789 1720
ZUVS 22	204	73	176	88	1,0	22 mm	1,3	2,3	7640148632614	789 1722
ZUVS 25	207	64	188	88	1,2	G1	2,1	3,8	7640148632621	789 1725
ZUVS 32	239	81	203	88	1,4	G1 1/4	3,7	7,2	7640148632638	789 1732
ZUVS 40	273	83	235	88	1,5	G1 1/2	5	10,2	7640148632645	789 1740

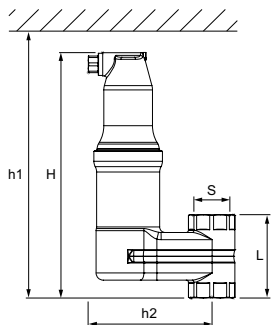

Zeparo ZUVL

Female thread. Vertical installation.

Type	H	h1	h2	L	m [kg]	S	qN [m ³ /h]	qN _{max} [m ³ /h]	EAN	Article No
ZUVL 20	222	247	112	71	1,8	Rp3/4	1,3	2,3	7640148632577	789 1220
ZUVL 25	222	247	112	75	1,8	Rp1	2,1	3,8	7640148632591	789 1225

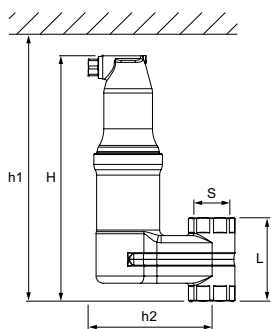

Zeparo ZUVLS solar

Female thread. Vertical installation.

Type	H	h1	h2	L	m [kg]	S	qN [m ³ /h]	qN _{max} [m ³ /h]	EAN	Article No
ZUVLS 20	222	247	112	71	1,8	Rp3/4	1,3	2,3	7640148632652	789 1820
ZUVLS 22	222	247	112	71	1,8	22 mm	1,3	2,3	7640148632669	789 1822
ZUVLS 25	222	247	112	75	1,8	Rp1	2,1	3,8	7640148632676	789 1825

qN = Nominal flow/flow rate

qN_{max} = Maximum flow

Zeparo ZUD/ZUM – Separator, version Dirt for sludge particles

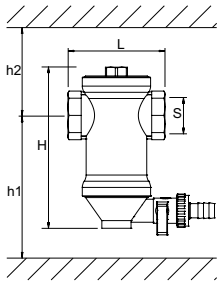

Zeparo ZUD

Female thread. Horizontal installation.

Type	H	h1	h2	L	m [kg]	S	qN [m ³ /h]	qN _{max} [m ³ /h]	EAN	Article No
ZUD 20	141	128	78	88	0,9	G3/4	1,3	2,3	7640148632683	789 2120
ZUD 25	144	140	69	88	1,0	G1	2,1	3,8	7640148632706	789 2125
ZUD 32	176	155	86	88	1,2	G1 1/4	3,7	7,2	7640148632713	789 2132
ZUD 40	210	187	88	88	1,4	G1 1/2	5,0	10,2	7640148632720	789 2140

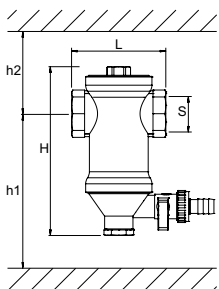

Zeparo ZUM with magnetic action

Female thread. Horizontal installation.

Type	H	h1	h2	L	m [kg]	S	qN [m ³ /h]	qN _{max} [m ³ /h]	EAN	Article No
ZUM 20	155	202	78	88	1,2	G3/4	1,3	2,3	7640148632768	789 3120
ZUM 25	158	214	70	88	1,3	G1	2,1	3,8	7640148632782	789 3125
ZUM 32	190	229	86	88	1,5	G1 1/4	3,7	7,2	7640148632799	789 3132
ZUM 40	224	261	86	88	1,6	G1 1/2	5	10,2	7640148632805	789 3140

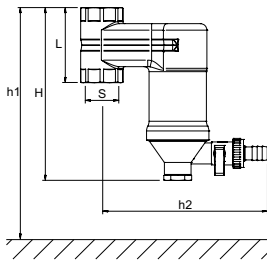

Zeparo ZUML with magnetic action

Female thread. Vertical installation.

Type	H	h1	h2	L	m [kg]	S	qN [m ³ /h]	qN _{max} [m ³ /h]	EAN	Article No
ZUML 20	171	271	165	71	1,8	Rp3/4	1,3	2,3	7640148632812	789 3220
ZUML 25	173	273	165	75	1,8	Rp1	2,1	3,8	7640148632836	789 3225

qN = Nominal flow/flow rate

qN_{max} = Maximum flow

Zeparo ZUK – Separator, version Kombi for micro bubbles and sludge particles

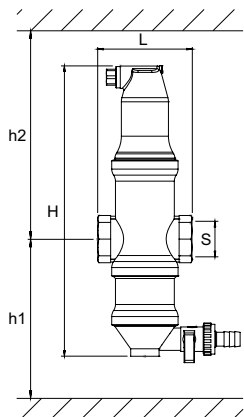

Zeparo ZUK

Female thread. Horizontal installation.

Type	H	h1	h2	L	m [kg]	S	qN [m ³ /h]	qN _{max} [m ³ /h]	EAN	Article No
ZUK 20	267	156	176	88	1,5	G3/4	1,3	2,3	7640148632843	789 4120
ZUK 25	270	148	186	88	1,6	G1	2,1	3,8	7640148632867	789 4125
ZUK 32	302	164	203	88	1,8	G1 1/4	3,7	7,2	7640148632874	789 4132
ZUK 40	336	166	235	88	1,9	G1 1/2	5	10,2	7640148632881	789 4140

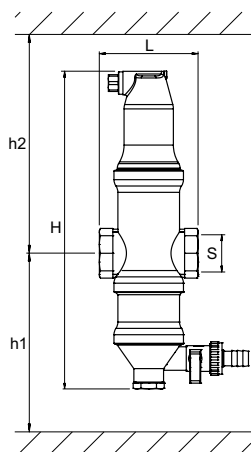

Zeparo ZUKM

Dry magnetic rod in pocket to increase the magnetite capture.

Female thread. Horizontal installation.

Type	H	h1	h2	L	m [kg]	S	qN [m ³ /h]	qN _{max} [m ³ /h]	EAN	Article No
ZUKM 20	281	230	176	88	1,6	G3/4	1,3	2,3	7640148632898	789 4220
ZUKM 22	281	230	176	88	1,5	22 mm	1,3	2,3	7640148632904	789 4222
ZUKM 25	284	221	186	88	1,7	G1	2,1	3,8	7640148632911	789 4225
ZUKM 32	316	238	203	88	1,9	G1 1/4	3,7	7,2	7640148632928	789 4232
ZUKM 40	350	240	235	88	2,0	G1 1/2	5	10,2	7640148632935	789 4240

qN = Nominal flow/flow rate

qN_{max} = Maximum flow

Zeparo ZUCM – Low loss header, version Collect with separator for micro bubbles and sludge particles

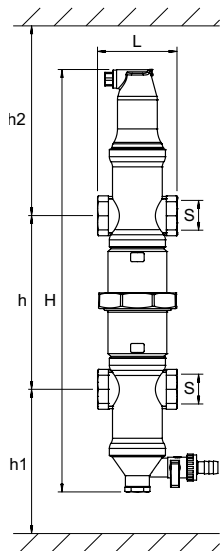

Zeparo ZUCM with magnetic action

Dry magnetic rod in pocket to increase the magnetite capture.
Female thread. Horizontal installation.

Type	H	h	h1	h2	L	m [kg]	S	qN [m ³ /h]	qN _{max} [m ³ /h]	EAN	Article No
ZUCM 20	464	211	202	176	88	2,9	G3/4	1,3	2,3	7640148632997	789 5220
ZUCM 25	470	193	214	186	88	3,2	G1	2,1	3,8	7640148633017	789 5225
ZUCM 32	534	227	229	203	88	3,7	G1 1/4	3,7	7,2	7640148633024	789 5232
ZUCM 40	602	231	261	235	88	4,0	G1 1/2	5	10,2	7640148633031	789 5240

qN = Nominal flow/flow rate

qN_{max} = Maximum flow

Accessories for separators



Zeparo ZPR – Redox anode, replacement for Zeparo ZUR

Heating, solar and cooling water systems.

With Redox granules for reduction of oxygen and improve water quality.

Water without inhibitors.

Max. admissible temperature: 110 °C. Min. admissible temperature: -10 °C.

Max. admissible pressure: 10 bar. Min. admissible pressure: 0 bar.

Type	m [kg]	S	EAN	Article No
ZPR	0,2	G1/2		789 6000

Zeparo ZHU – Thermal insulation for Zeparo ZUC, ZUD, ZUK, ZUT, ZUV

Heating water systems.

Expanded polypropylene (EPP), anthracite.

Insulation value approx. 0.035 W/mk.

Fire rating B2 to DIN 4102.

Max. admissible temperature: 110 °C.

Min. admissible temperature: 10 °C.

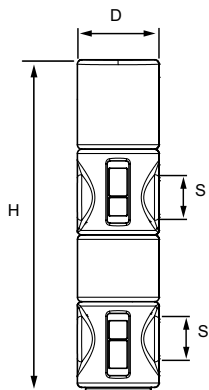
ZHU-ZUC/ZUCM

D	H	SD	m [kg]	S [DN]	EAN	Article No
112	447	24	0,142	25	7640148639040	787 1525
112	511	24	0,146	32	7640148639088	787 1532
112	579	24	0,165	40	7640148639125	787 1540

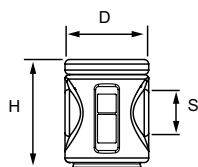
ZHU-ZUD/ZUM

D	H	SD	m [kg]	S [DN]	EAN	Article No
112	144	24	0,044	20-22	7640148638982	787 1422
112	147	24	0,053	25	7640148639033	787 1425
112	179	24	0,055	32	7640148639071	787 1432
112	239	24	0,064	40	7640148639118	787 1440

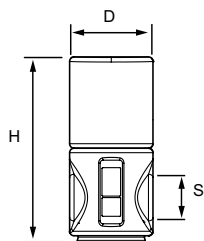
ZHU-ZUK/ZUKM

D	H	SD	m [kg]	S [DN]	EAN	Article No
112	244	24	0,070	20-22	7640148638975	787 1322
112	247	24	0,079	25	7640148639019	787 1325
112	279	24	0,080	32	7640148639064	787 1332
112	313	24	0,090	40	7640148639101	787 1340

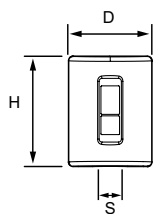
ZHU-ZUT

D	H	SD	m [kg]	S [DN]	EAN	Article No
112	147	24	0,058	15-25	7640148639026	787 1125

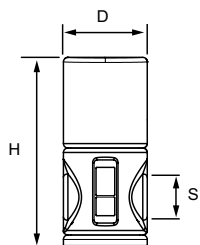
ZHU-ZUV

D	H	SD	m [kg]	S [DN]	EAN	Article No
112	258	24	0,079	20-22	7640148638968	787 1222
112	261	24	0,088	25	7640148639002	787 1225
112	293	24	0,090	32	7640148639057	787 1232
112	327	24	0,100	40	7640148639095	787 1240