

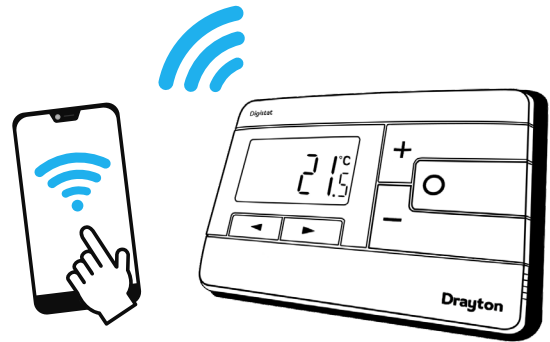

# Smart, simple, sustainable

The New Digistat



User guide  
Set-up and control

**Drayton**

by **Schneider** Electric

Digistat System ..... 3

Controlling the Digistat using the Wisser Home app ..... 4

Download the Wisser Home app to your smartphone ..... 5

Setting up the app ..... 6

Pairing the app with your Digistat and create your account ..... 7

Control your heating ..... 8-10

Using Away Mode ..... 11

Using Smart Modes ..... 12

Using the Digistat without the app ..... 13

The essentials ..... 14

The display in more detail ..... 15

The settings menu ..... 16

User Settings, options and defaults ..... 17

Advanced User Settings, options and defaults ..... 18

Understanding schedules ..... 19

Understanding preset schedules ..... 20

Customising your schedule ..... 21

Boosting your heating ..... 22

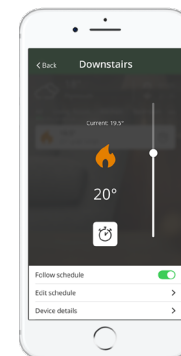
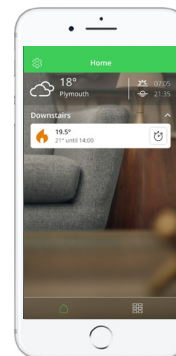
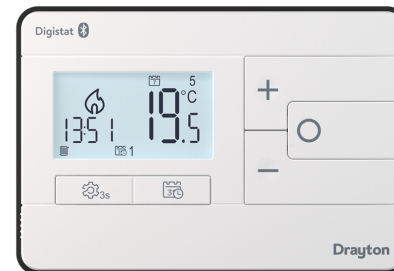

## Using the new Drayton Digistat

Drayton's latest generation of wired and wireless Digistat Thermostats bridges the gap between traditional thermostats and smart systems

Providing unparalleled flexibility and the ultimate in control for the homeowner via the app

You can control your heating directly from the Digistat itself using the 5 buttons and the backlit display

Or if you prefer you can connect your smart phone to the Digistat using Bluetooth and control everything for the palm of your hand



## Of course using your Digistat is so much easier if you use your smartphone

With the free smartphone app you can adjust schedules, boost your heating, set a holiday period and set away mode, all from your smartphone in the palm of your hand

With the app downloaded your smartphone connects directly to your Digistat using the phone's Bluetooth technology with no need for Wi-Fi, internet broadband or cloud connectivity. It's just a simple way to use your Digistat from anywhere in the home (typical Bluetooth range)

.....  
The Bluetooth® word mark and logos are registered trademarks owned by Bluetooth SIG, Inc. and any use of such marks by Schneider Electric is under license. Other trademarks and trade names are those of their respective owners.

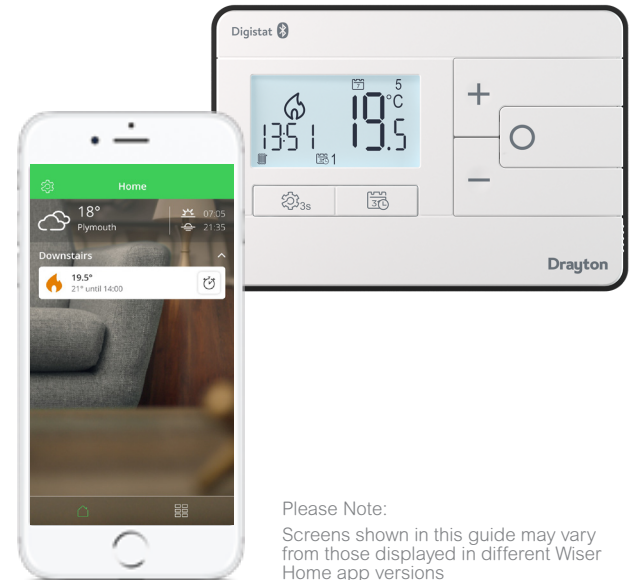

Please Note:  
Screens shown in this guide may vary from those displayed in different Wisser Home app versions



## Step 1: Download the Wiser Home app

Download the Wiser Home app for your mobile device from the App Store® or Google Play™



- ➔ Search for Wiser Home
- ➔ Download the Wiser Home app

The Wiser Home app guides you through the whole set-up process

---

### System requirements

The Wiser Home app is available for Apple® iOS and Android™ mobile devices. Due to the large number of mobile devices available on the market, compatibility cannot be guaranteed with every model. The mobile device must fulfil the following minimum technical requirements:

- Android™ Version 9 or higher
- Apple® iOS 12 or higher
- Bluetooth version 4.2 or higher



Step 2: Open Wisier Home app

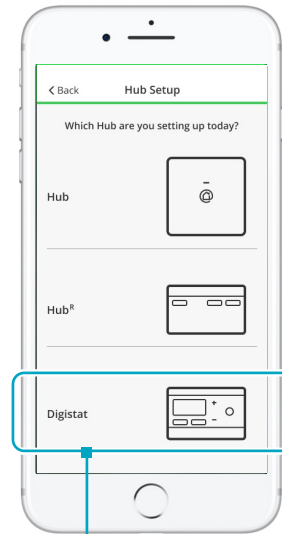
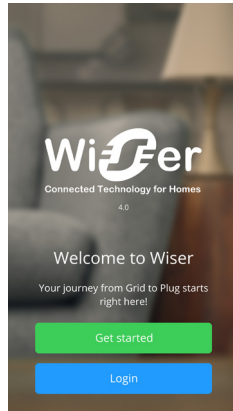

- ➡ On the welcome screen select "Get Started"
- ➡ Then select Digistat

## Pairing

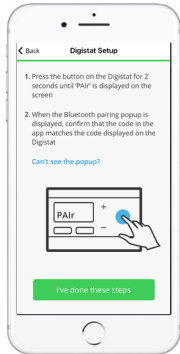

## Confirming

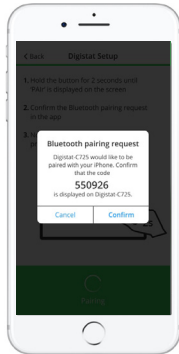

## Renaming



## Account creation

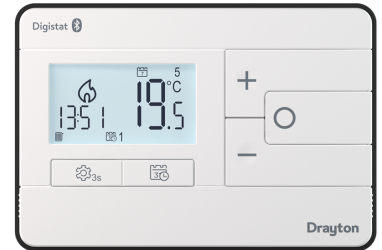
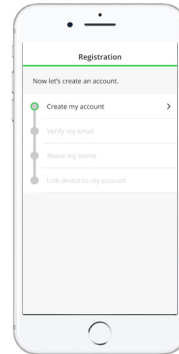

Just follow the instructions in the app...

+ —————  
You're done!  
Now start playing  
with your Digistat.....



Home screen

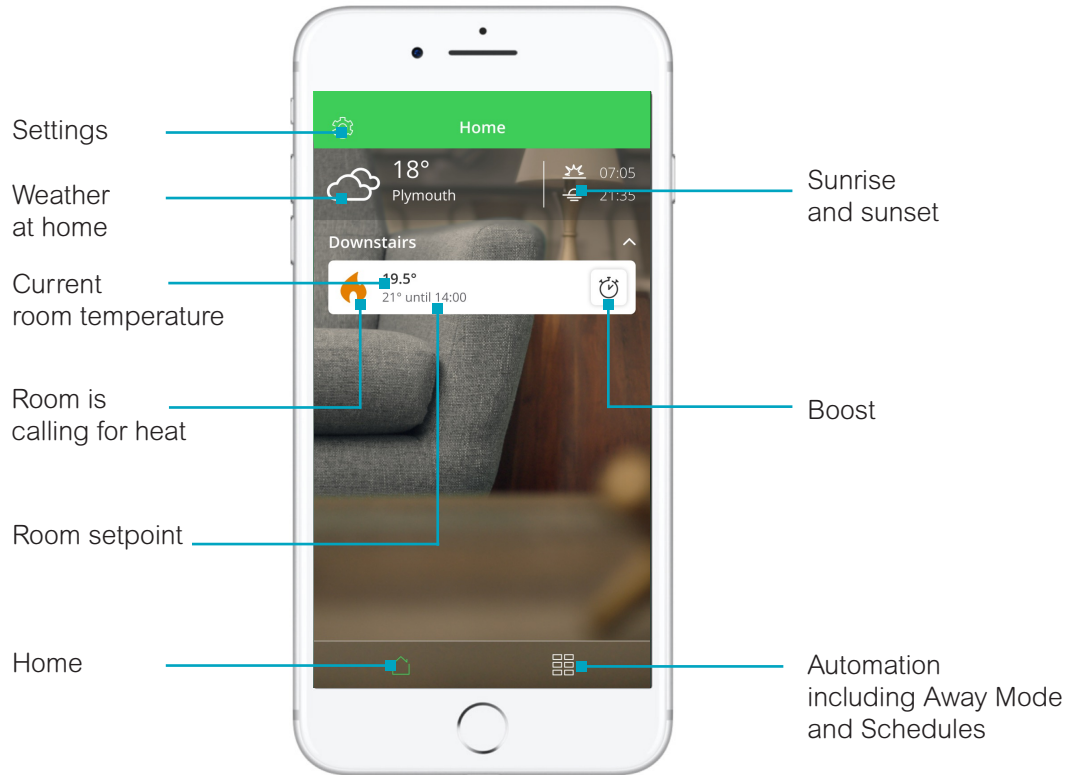

Room View

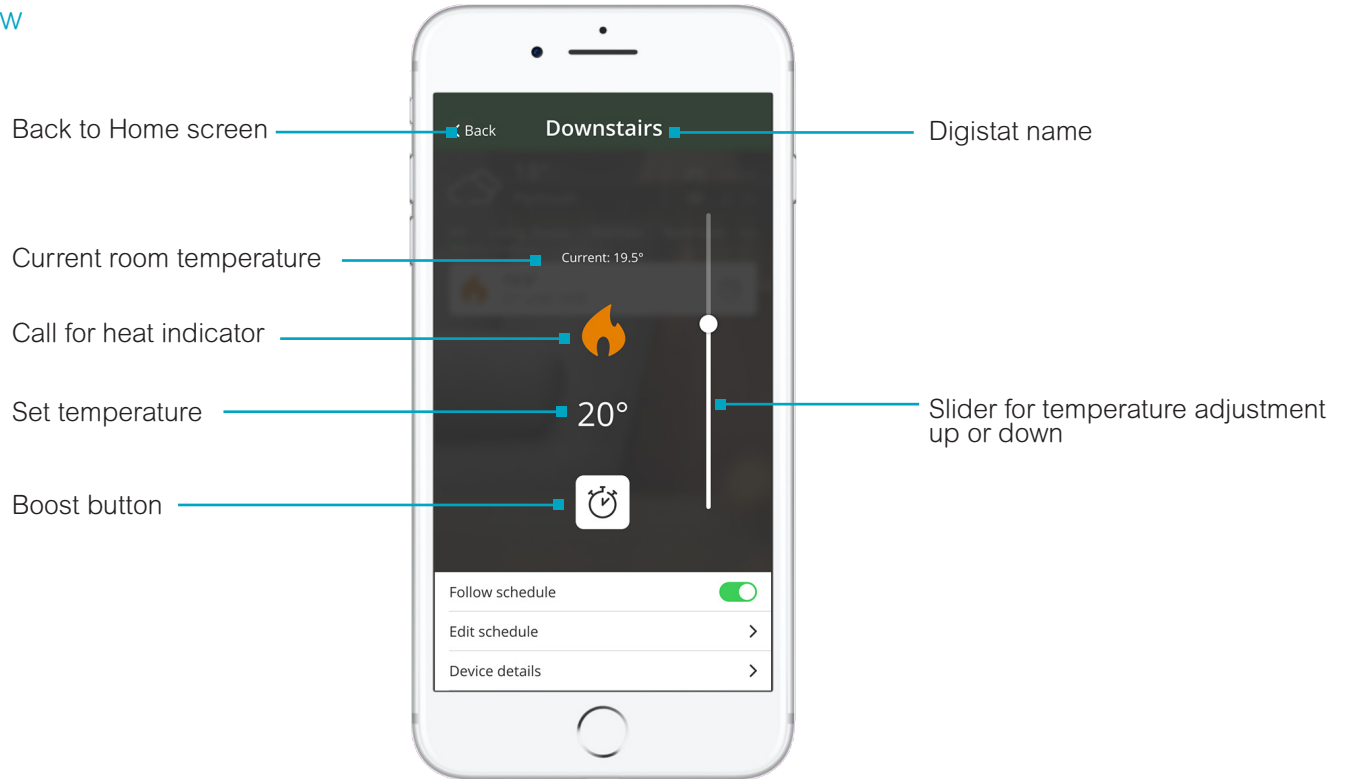

The Schedule Screen

Back to Home

Day being viewed

Time and temperature events

Copy the schedule to other days

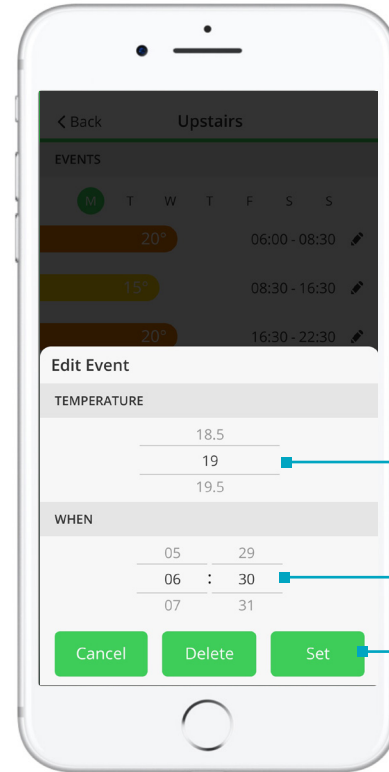
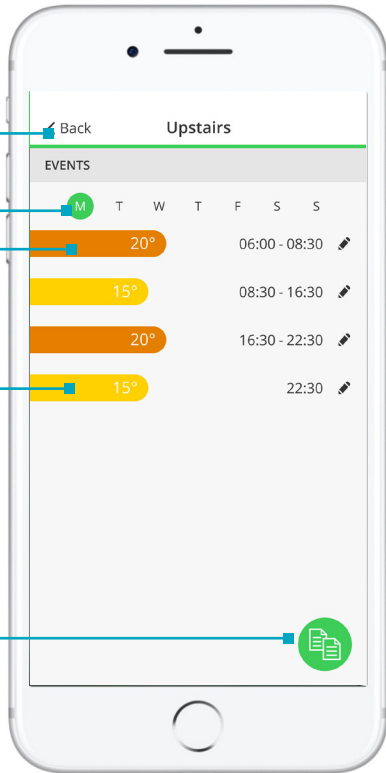

Adjust the temperature

Set the start time

Confirm

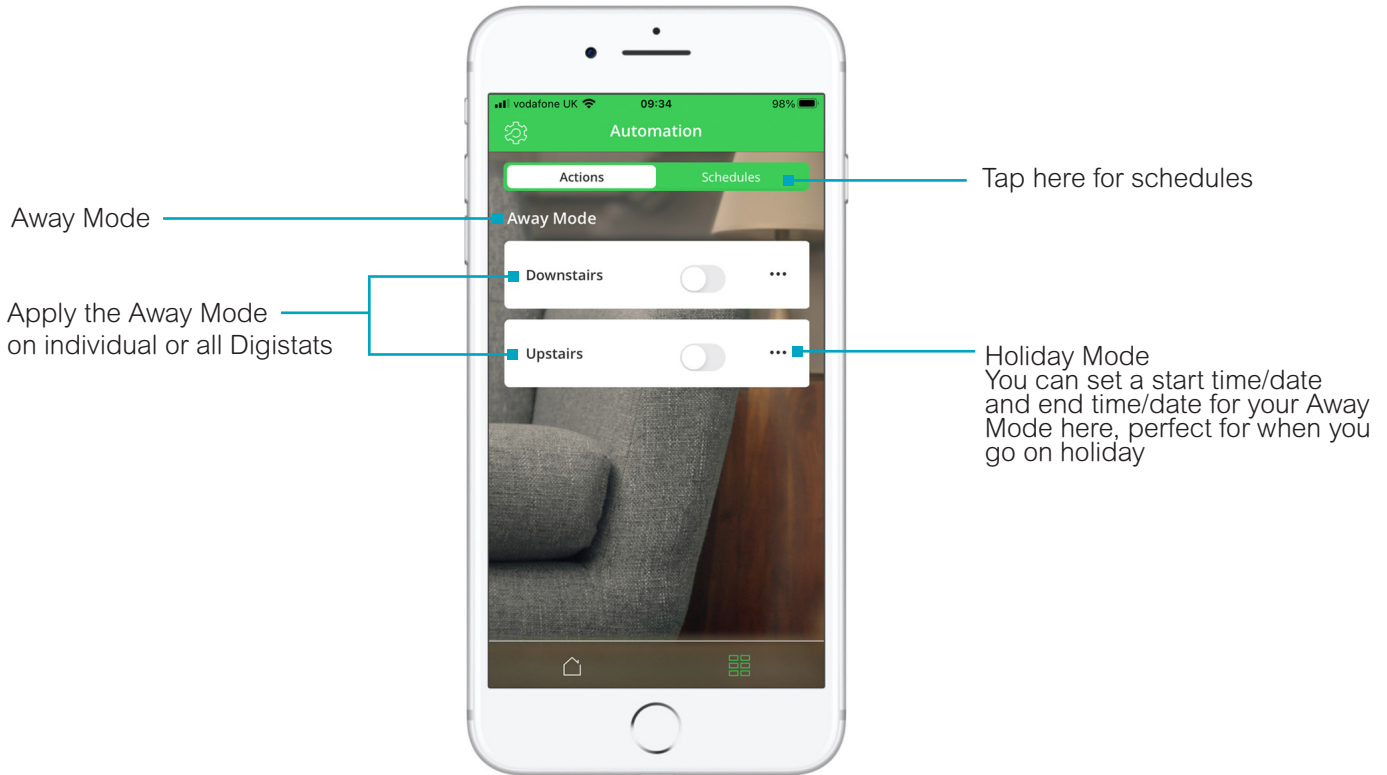

Away Mode appears in the Automation menu



## Smart modes help to save you money or to improve comfort levels

### Delayed Start

When activated Delayed Start will save you money by delaying start times, effectively adapting your schedule to optimise energy usage based on a learning mode that takes into account the thermal characteristics of your home and the weather forecast

### Optimum Start

When activated Optimum Start will improve comfort on colder days when the home takes longer to heat up. This is a learning mode which takes into account the thermal characteristics of your home and the weather forecast, and it will turn on your heating earlier to ensure that the set temperature is achieved by the required time in the schedule

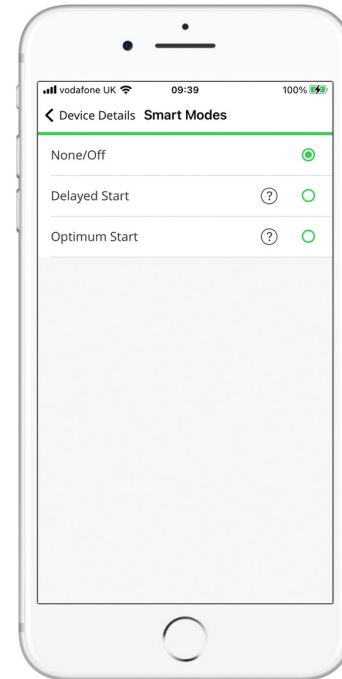

## The new Digistat can also be used without the app

The next pages explain how you set up the Digistat according to your lifestyle and how you make day-to-day changes such as applying a BOOST or setting Holiday Mode



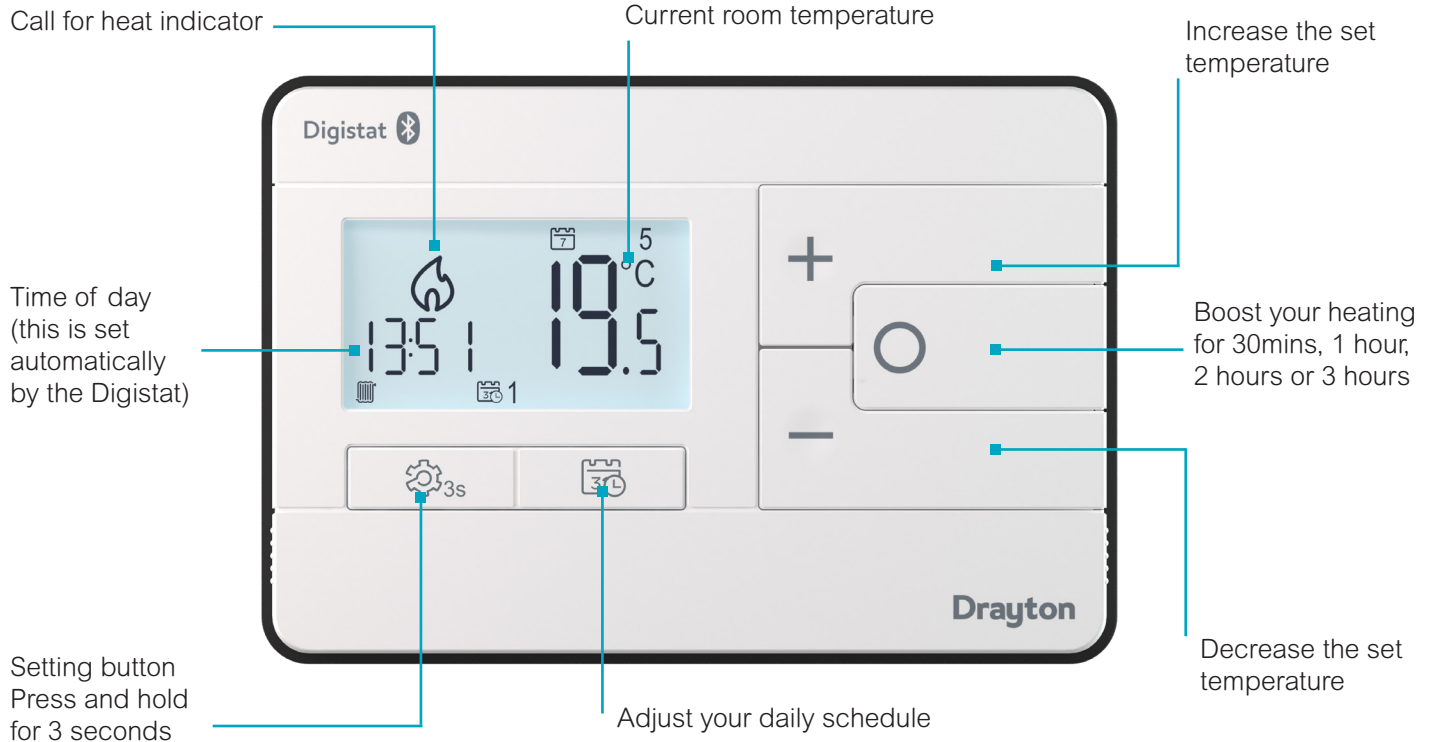

+ Note: pressing any button turns on the display backlight

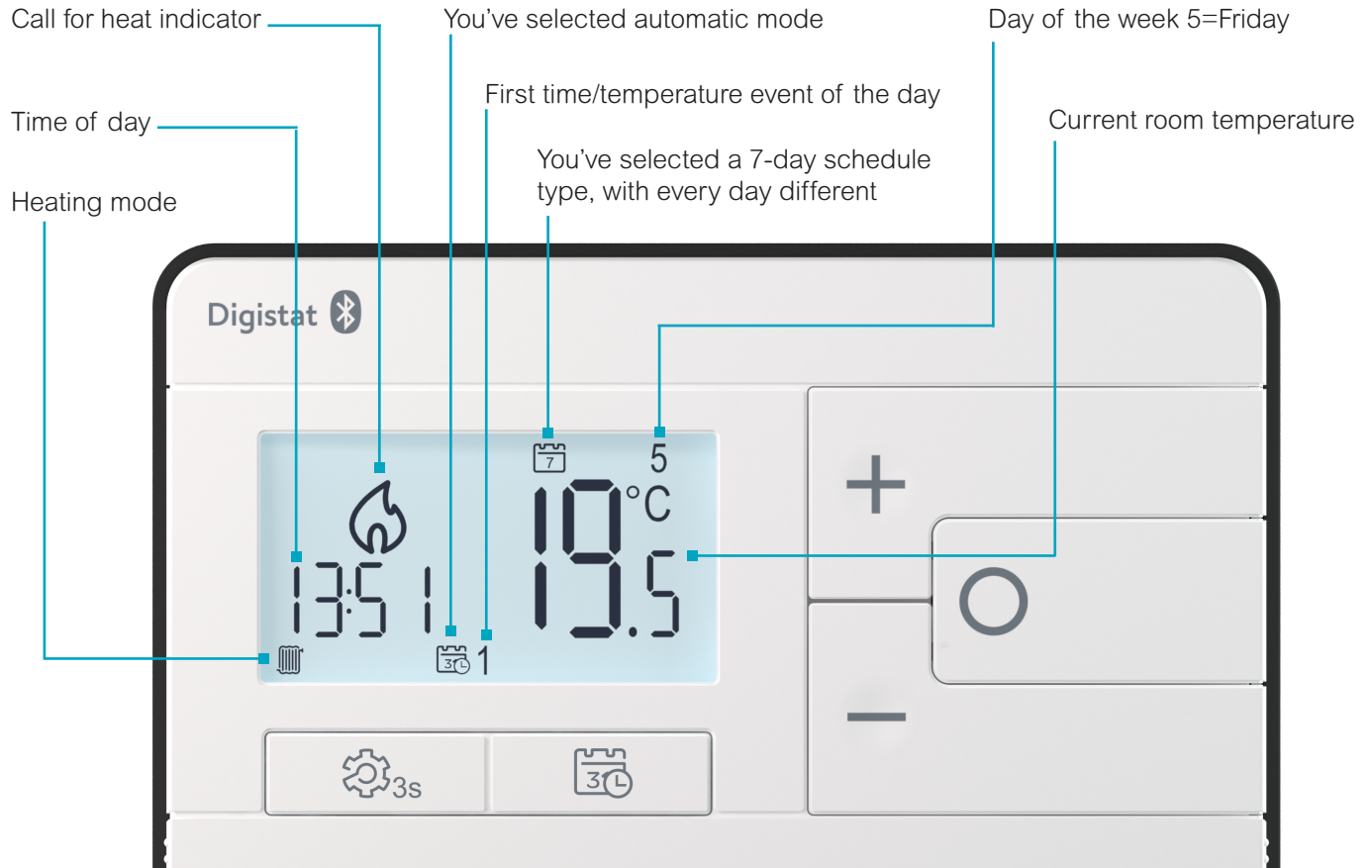

Before you start it's worth checking that the Digistat has been correctly set for your specific needs

Use these setting to adjust:

### User settings (USEr 01 menu):

- Change from automatic to manual mode, or turn the thermostat OFF
- Set a holiday period (turn OFF the thermostat for a set period)

### Advanced user settings (AdvU 02 menu):

- Set the time of day
- Set the date
- Choose a 12-hour or 24-hour clock
- Switch OFF daylight saving time
- Apply a temperature offset
- Lock the display
- Set the backlight ON time
- Choose between a 7-day, 5/2-day, 24hour or manual schedule
- Choose between 3 preset schedules
- Return to factory settings

In this menu you will also find the Installer Menu (InSt 03) and the Service Interval menu (Ser 04) but these should only be adjusted by the installer

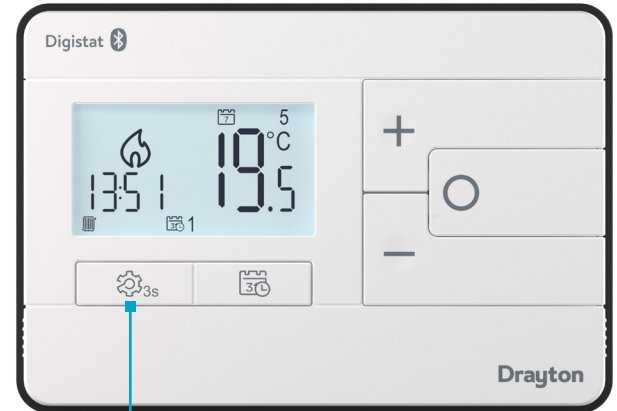

### Settings button

- ➡ Press and hold for 3 seconds to access
- ➡ Then use the + and – buttons to navigate  
And the O button to confirm any new settings
- ➡ In the mode the Settings button can be used as a back button to exit

USER 01 Menu	Options	Default	Note
Mode	Automatic (AUTO), Manual (MAN)	Automatic (AUTO)	Automatic mode applies the set schedule
			Manual mode provides temperature control only
Holiday Mode (HOL)	Set the start date and time	Today's date and time	
	Set the end date and time	In 7 days time	
	Set the temperature while you are away	10°C	

AdvU 02 Menu	Menu item name	Options	Default	Note
Time of day	tIME 01	Set or adjust the time of day	Automatically factory-set by the Digistat	
Date	dAtE 02	Set or adjust the date	Automatically factory-set by the Digistat	
Clock format	12:24 03	12-hour or 24-hour clock display	12-hour clock	
Daylight saving time	dSt 04	ON or OFF	ON	
Temperature Offset	OSEt 05	-5° to +5°C in 0.1°C increments	0.0°C	
Display Lock	LOC 06	ON or OFF	ON	Set a 3-digit code to lock
Backlight ON time	bALt 07	OFF, 10secs, 20 secs	10 secs	
Schedule Type	ProG 08	7 day, 5/2 day, 24 hour, none	7 day	
Preset schedule	PSEt 09	1 (heating morning and evening), 2 (heating morning, noon, and evening) or 3 (heating all day)	1	
Reset to factory settings	rPSt 12	Yes or No	No	



Schedule Types	Select in Advanced User settings, item Prog 08
7 day	Every day can be programmed differently - This is great if you have a very flexible lifestyle
5/2 day	Weekdays all the same but weekend programmed differently - This schedule is ideal if your work days are the same every day
24 hour	Every day the same - If you work from home or are retired then this schedule will be more suitable
None	The thermostat controls temperature only all the time - Use this setting if you want to keep your home at the same temperature at all times

Preset 1		All day		5/2 day			
Event	Time	Temp	Weekdays		Weekend		
1	06:30	20.0°C	06:30	20.0°C	07:00	20.0°C	
2	08:30	16.0°C	08:30	16.0°C	09:00	18.0°C	
3	16:30	21.0°C	16:30	21.0°C	16:00	21.0°C	
4	22:30	OFF	22:30	OFF	23:00	OFF	

Preset 2		All day		5/2 day			
Event	Time	Temp	Weekdays		Weekend		
1	06:30	20.0°C	06:30	20.0°C	07:00	20.0°C	
2	08:30	16.0°C	08:30	16.0°C	09:00	18.0°C	
3	12:00	21.0°C	12:00	21.0°C	12:00	21.0°C	
4	14:00	16.0°C	14:00	16.0°C	14:00	18.0°C	
5	16:30	21.0°C	16:30	21.0°C	16:00	21.0°C	
6	22:30	OFF	22:30	OFF	23:00	OFF	

Preset 3		All day		5/2 day			
Event	Time	Temp	Weekdays		Weekend		
1	06:30	20.0°C	06:30	20.0°C	07:00	20.0°C	
2	22:30	OFF	22:30	OFF	09:00	18.0°C	
3					16:00	21.0°C	
4					23:00	OFF	

## Setting up Times/Temperatures on the Digistat

1. With the product operating as normal in Auto Mode, press  once. Use + and – to select the day or set of days you want to adjust the times and temperatures for. Press O to confirm.



2. The time on the display will now be flashing as shown, use + and – to adjust the first period start time. Press O to confirm.

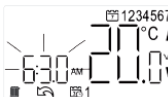

3. Once the time has been set the temperature on the display will now be flashing, use + and – to adjust the temperature for the first time period. Press O to confirm.



4. Move to the next time and temperature periods and adjust as needed, confirming the changes by pressing O. The new schedule will be saved pressing O when the word SAVE is flashing.



5. In Pre-set Program 1 you will have 4 time periods available, to add more (max. 8 per day) press + when you see the SAVE option on-screen and time period 5 at the bottom of the screen, to scroll to the Add option. Press O to add time period then adjust time and temperature as required.



6. To exit press  to go back until you return to the home screen.

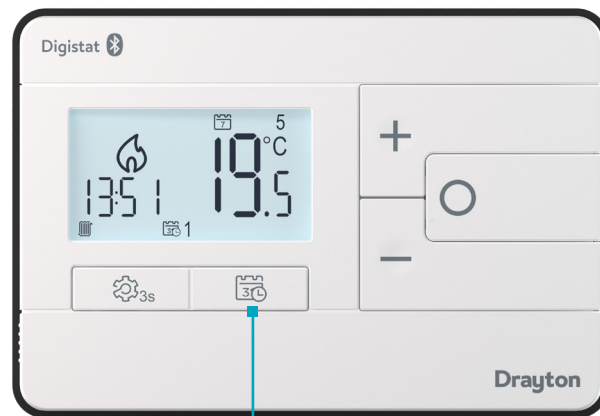

Schedule button

## Setting a BOOST means applying a new set temperature for a short period of time

You can boost for 30 minutes, one hour, two hours or three hours

When the BOOST has expired the normal schedule takes over

After pressing the Boost Button (O) you set the length of time for the boost and then the temperature, adjusting with the + and - buttons confirming each one with O button

The Digistat remembers your last BOOST so if you want to repeat the previous boost you just press O three times

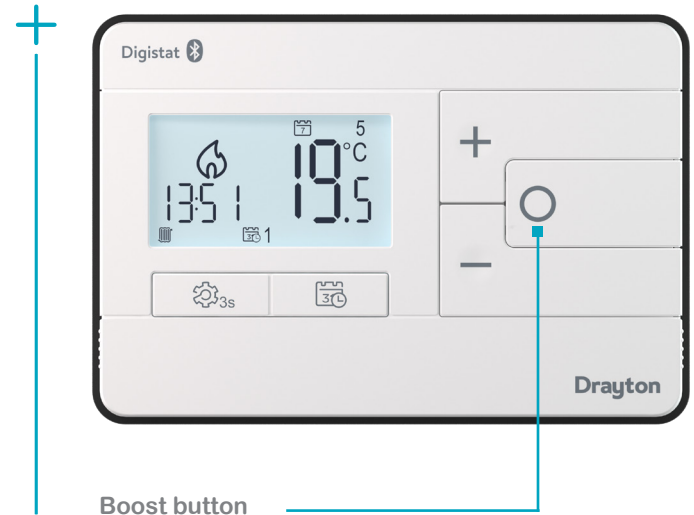

## Trademarks

- The Bluetooth® word mark and logos are registered trademarks owned by Bluetooth SIG, Inc. and any use of such marks by Schneider Electric is under license. Other trademarks and trade names are those of their respective owners.

Other brands and registered trademarks are the property of the relevant owner.

Please Note: Information in this guide is subject to change as these products evolve. Screen graphics and descriptions in this guide may not reflect exactly the latest product configuration.

Customer Service Tel: +44 333 6000 622\*

Technical Helpline: +44 333 6000 622\*

\*Please note that international call charges may apply to those calling from outside of the UK.

Website: [wiser.draytoncontrols.co.uk](https://www.wiser.draytoncontrols.co.uk)

E-mail: [customer.care@draytoncontrols.co.uk](mailto:customer.care@draytoncontrols.co.uk)

 @DraytonHome

 /DraytonControls

 /DraytonHome

 /DraytonHome



BRITISH BUILT TO LAST

06490331001 Iss A