



50051982-004 A

Room temperature



Set temperature, inquiry

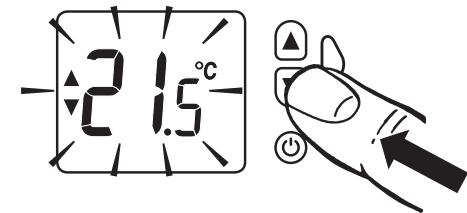

Set temperature, adjustment

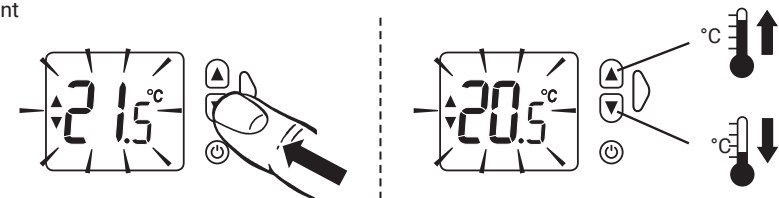

Switch ON/OFF  
(frost protection enabled)

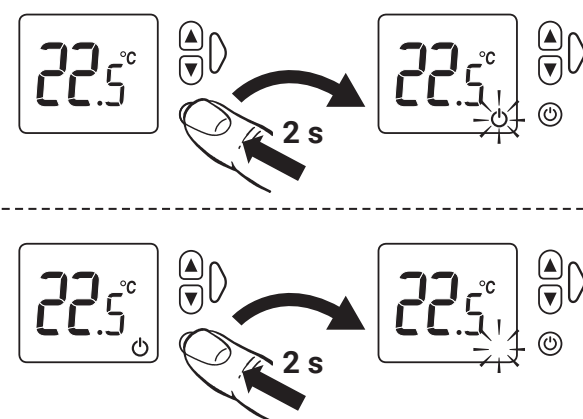

1

### Operating indicators

Heating demand indicator

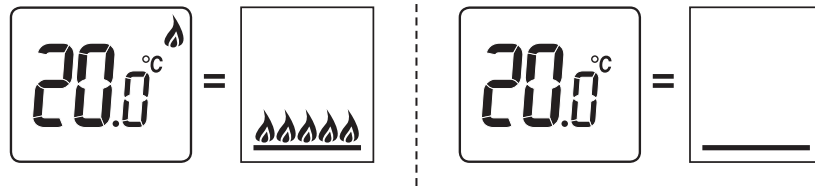

Frost protection  
(not available in cooling operation)



Fault indicator

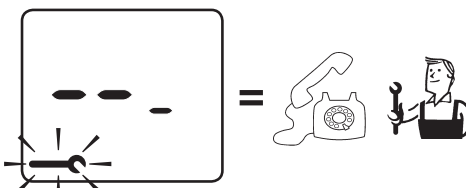

Low battery indicator

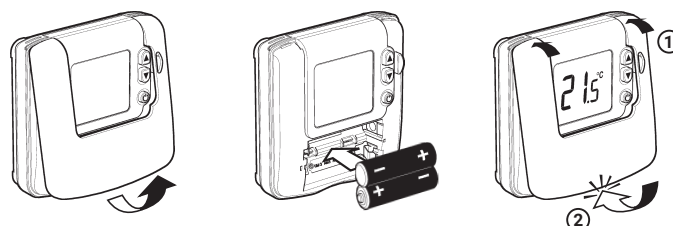
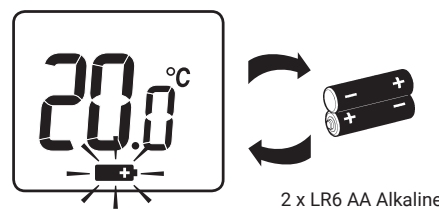

2

Heat/cool  
changeover

Installer Parameter "HC"  
(Heat/cool changeover)  
must be set to "1"

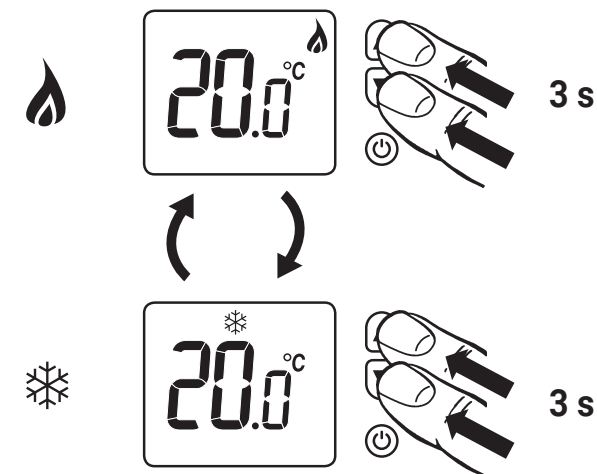

### Energy Saving ECO feature

Pressing the green ECO button  
gives a timed period at a different,  
predefined temperature (18°C)

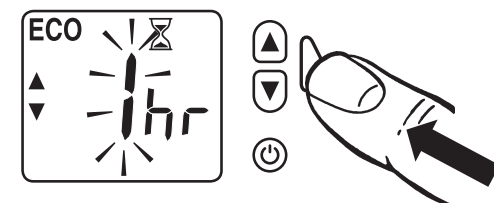

To set the ECO energy savings time period

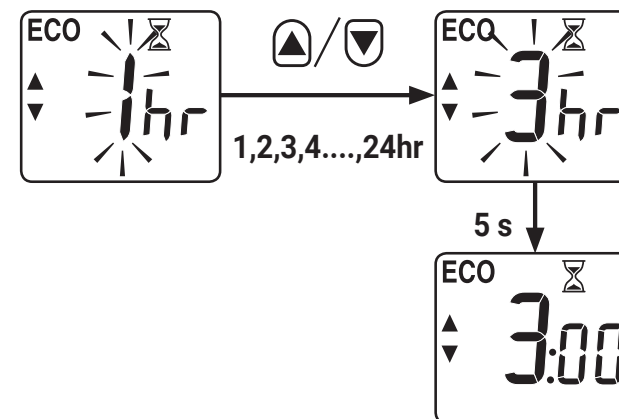

3

Display shows countdown of  
ECO time remaining

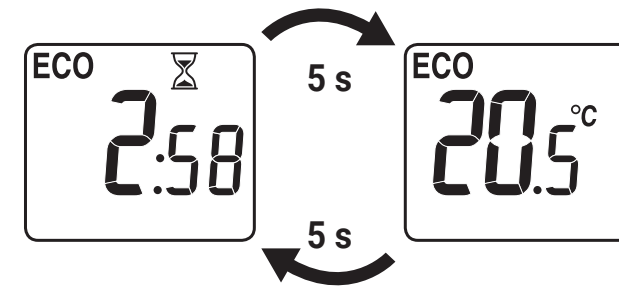

Pressing ▲ or ▼ will now allow the  
ECO temperature to be changed

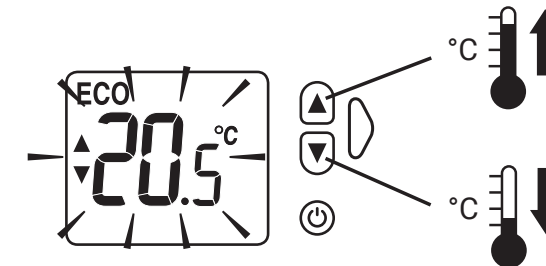

To exit ECO mode, press ECO button  
again

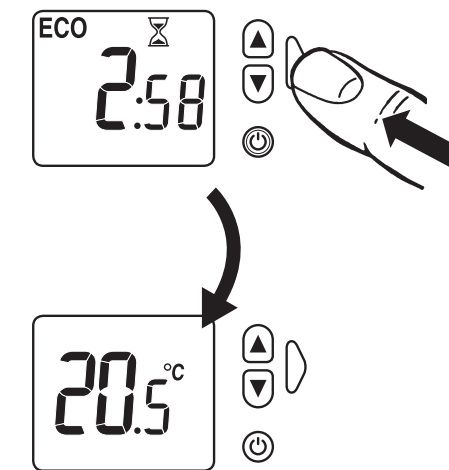

4

# TotalHome®

## WIRED DIGITAL ROOM THERMOSTAT

### Installation Guide

TTHWD

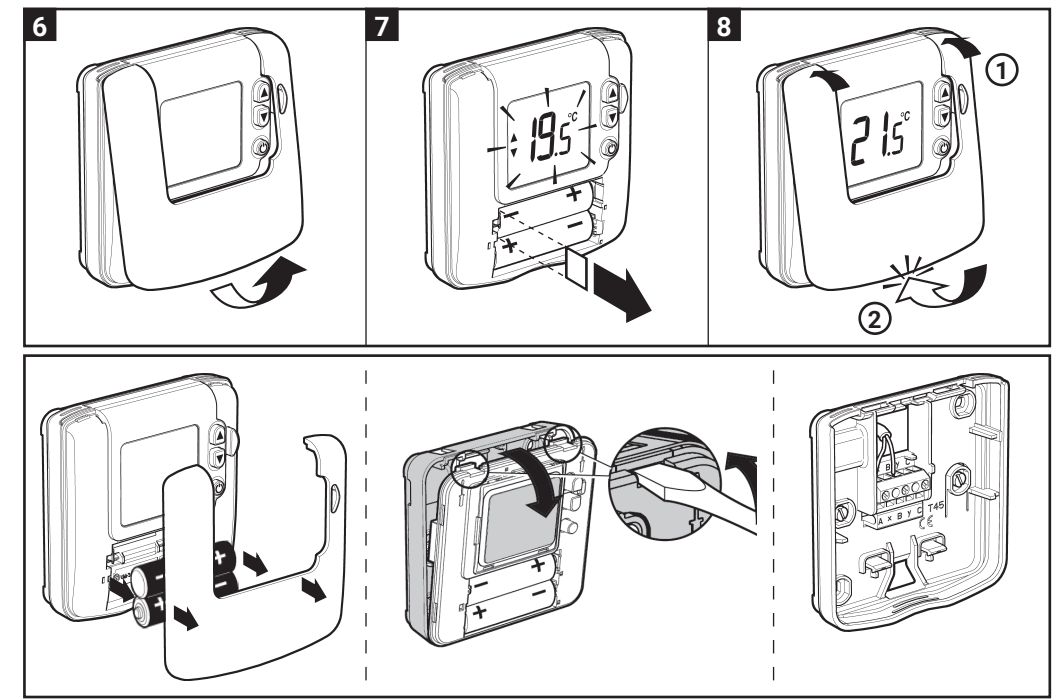
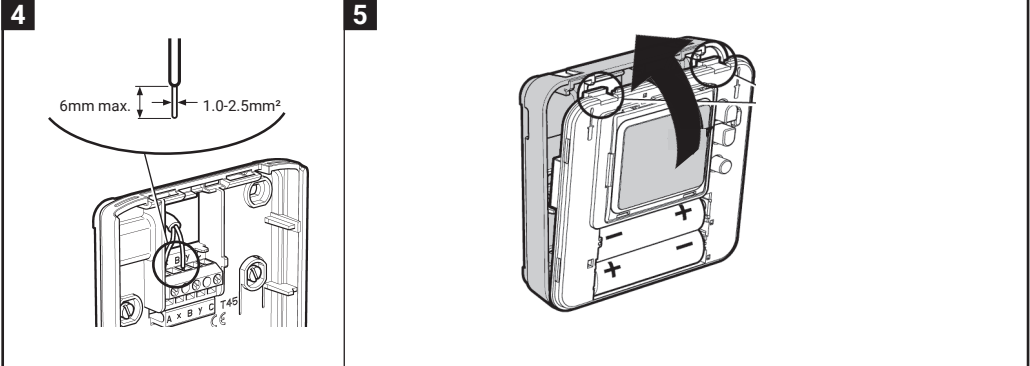
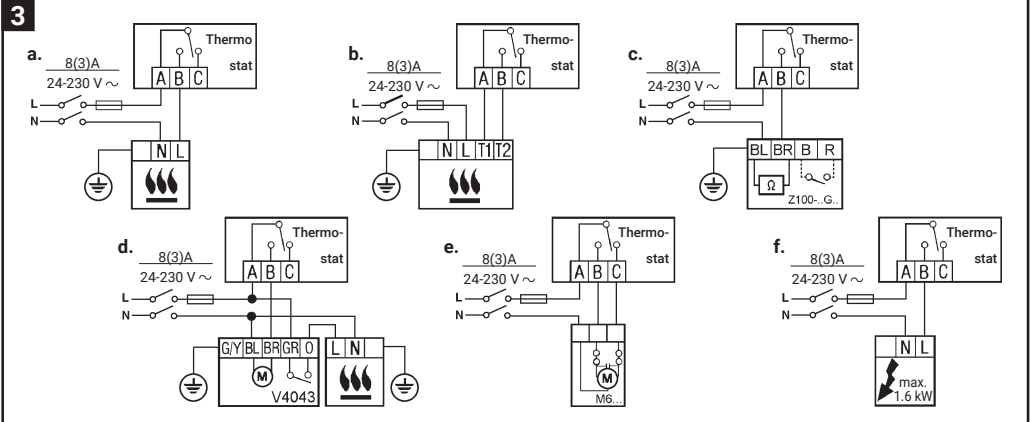
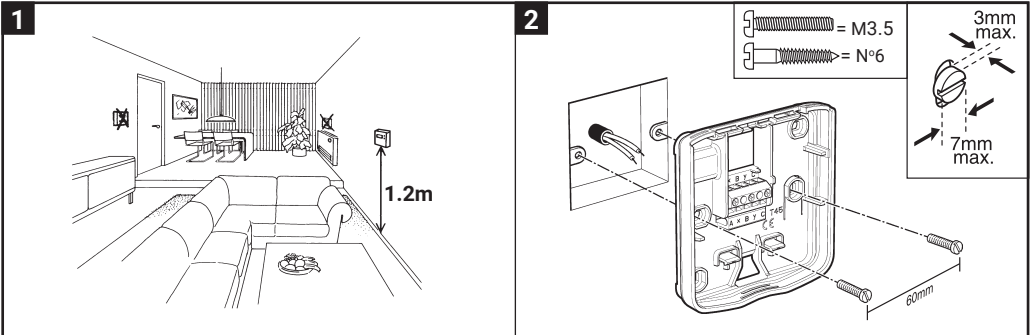

### Installer Mode

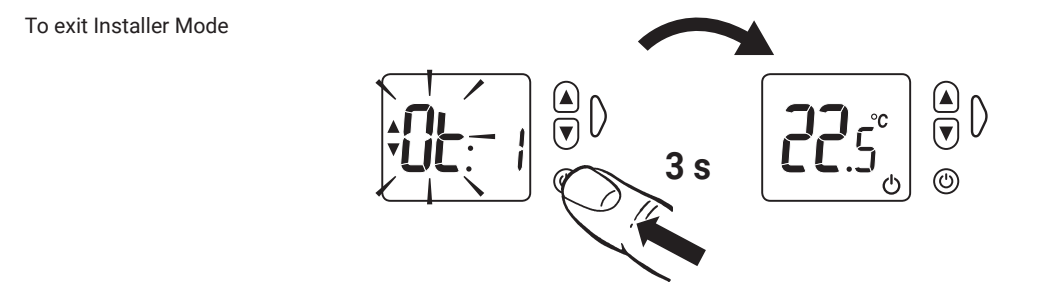
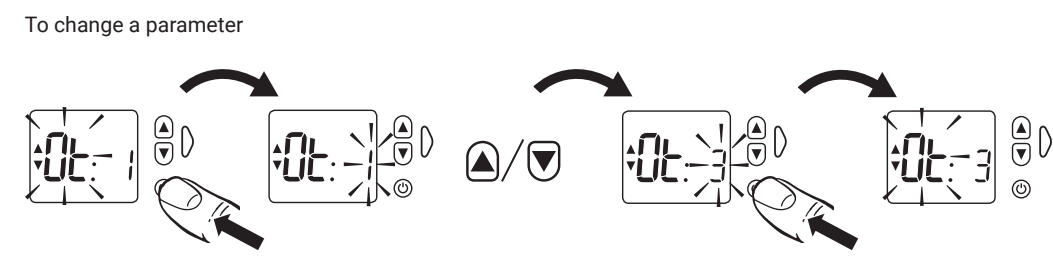
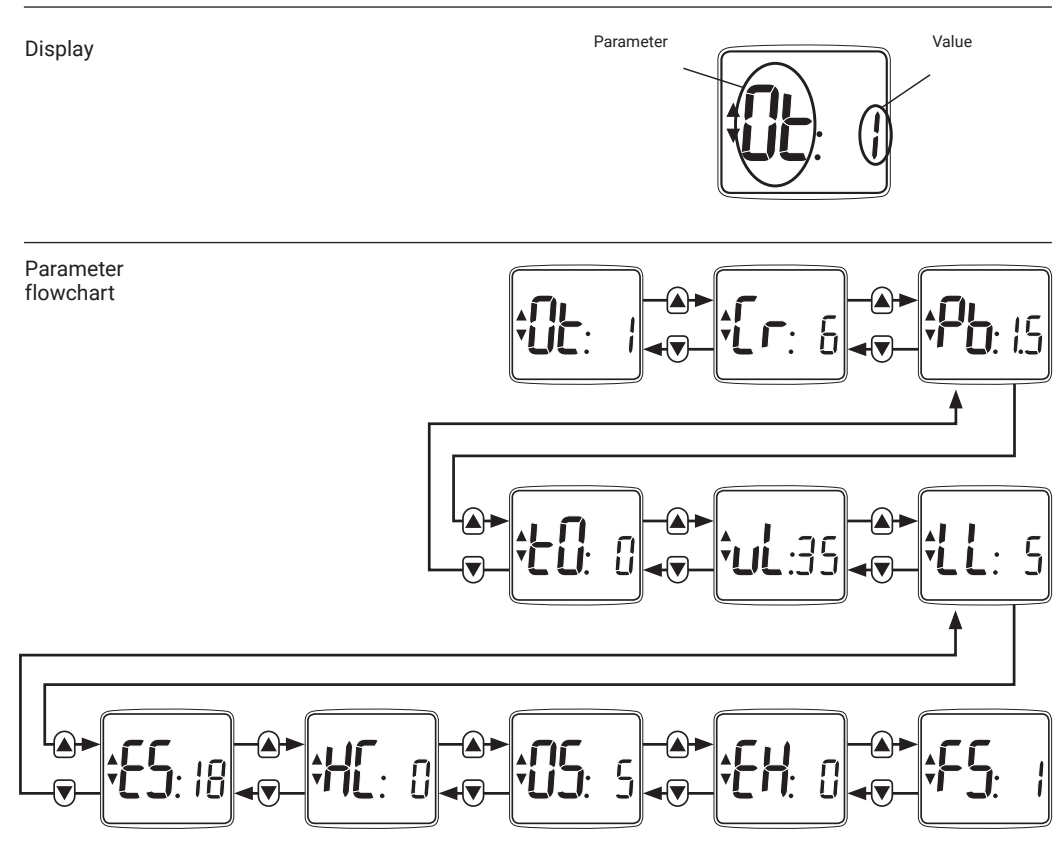
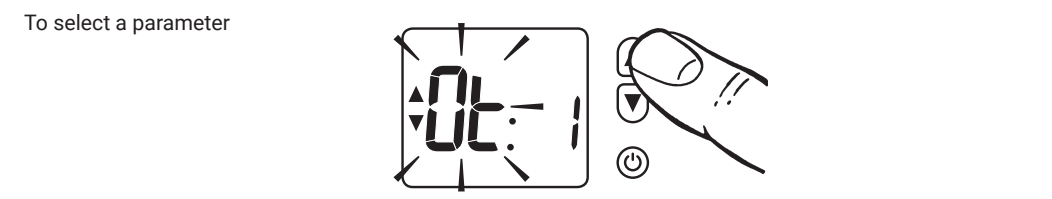
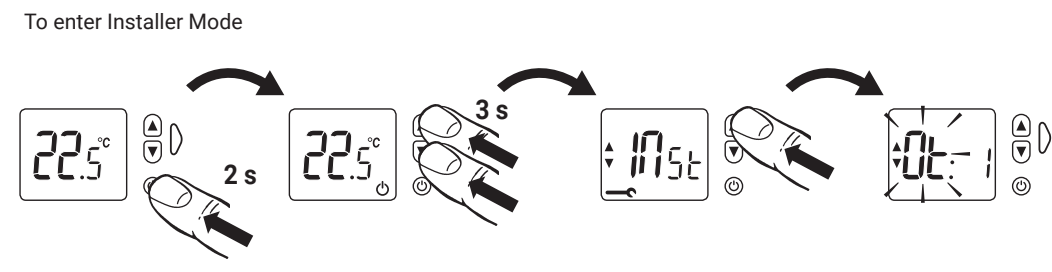

### Parameters

Description	Parameter	Range of values	Default
Minimum ON/OFF time	Ot	1,2,3,4,5 m	1 m
Cycle rate	Cr	{3,6,9,12}	6
Proportional band width	Pb	1.5 ... 3.0 K	1.5K
Temperature measurement offset	tO	-3 ... 3 K	0 K
Upper setpoint limit	uL	21 ... 35 °C	35°C
Lower setpoint limit	LL	5 ... 21 °C	5°C
ECO temperature	ES	5 ... 35 °C	18 °C
Heat/cool changeover	HC	0, 1 (0 = Disable) (1 = Enable)	0
Off setpoint adjust	OS	- (= Off), 5...16°C	5°C
Electric heat	EH	0 (<3A) / 1 (3A - 8A)	0 (<3A)
Reset parameters	FS	0 / 1	1 (factory)

FROM  
**resideo**  
www.resideo.com



© 2023 Resideo Technologies, Inc. All rights reserved.  
This product is manufactured by Resideo Technologies, Inc. and its affiliates.