



5 YEAR
WARRANTY



EASY
INSTALLATION



RECHARGEABLE
BATTERY



COMPATIBLE WITH
SMART HOME DEVICES



VERSATILE



ZIGBEE 3.0
2.4 GHz



PART OF
Salus
Smart Home

EL600F

SMART HOME THERMOSTAT

FOR THE SALUS SMART HOME SYSTEM



Quick Guide



Introduction

The **EL600F Elypso** is a ZigBee temperature controller for wireless control of a variety of devices, such as the KL08RF wiring centre, mini TRV head, RX10RF boiler control module.

In order to control EL600F over the Internet or via the SALUS Premium Lite mobile app (ONLINE mode), it must be installed together with the UGE600 or UG800 Internet gateways (sold separately). From the application level, it is possible to pair EL600F with other system elements, e.g. Smart Plug SPE600, Smart Relay SR600, Thermostatic Radiator Valves (TRVs) or other mentioned compatible devices. EL600F can be used locally without an Internet connection (OFFLINE mode), with ZigBee 3.0 devices like TRV3RF and RX30RF.

Product Compliance

This product complies with the essential requirements and other relevant provisions of Directives 2014/53/EU and 2015/863/EU. The full text of the EU Declaration of Conformity is available at the following internet address: www.saluslegal.com.

Ⓜ 2405-2480MHz, <14dBm



Safety Information

Use in accordance to national and EU regulations. Use the device as intended, keeping it in dry condition. Product for indoor use only. Installation must be carried out by a qualified person in accordance to national and EU regulations. Disconnect your equipment before cleaning it with a dry cloth.

Package content

- | | |
|----------------------|--|
| 1) EL600F Thermostat | 6) USB cable - type C |
| 2) Charging dock | 7) 2 x M3x25mm |
| 3) Wall plate | 8) 2x M3 x 15mm |
| 4) Mini wall plate | 9) 2x wall plugs |
| 5) User quick guide | 10) double sided adhesive mounting plate |

Before you start:

- 1 The EL600T Elypso Thermostat is partially charged, however, we recommend you to fully charge the battery before use. Connect the charger to USB Port type C which is at the back of the charging dock to charge the device.

Charging to full battery level may take up to 24h.

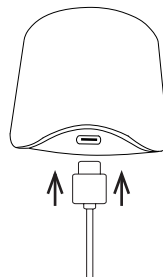

- 2 Mounting: to mount the thermostat the accessories included can be used (mounting screws and/or self adhesive tape).

For wall plate: Remove the backplate and mount it on the wall by using the screws provided. After that the wall plate can be attached to it.

For mini wall plate: Use the screws provided and/or self adhesive plate in order to fix it on the wall. After following the procedure for any of the wall plates the thermostat can be attached. Due to the built-in magnet, thermostat can be safely fixed in place.



Please note:

The ideal position for thermostat mounting is about **1.5 m above floor level** and **far from heating and cooling sources**. The thermostat should not be exposed to sunlight or any extreme conditions like for example draft.

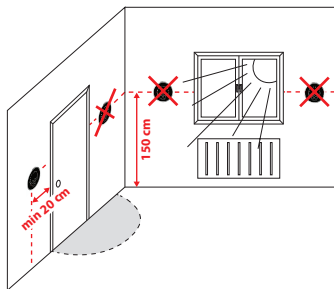

Screen's Icon Description

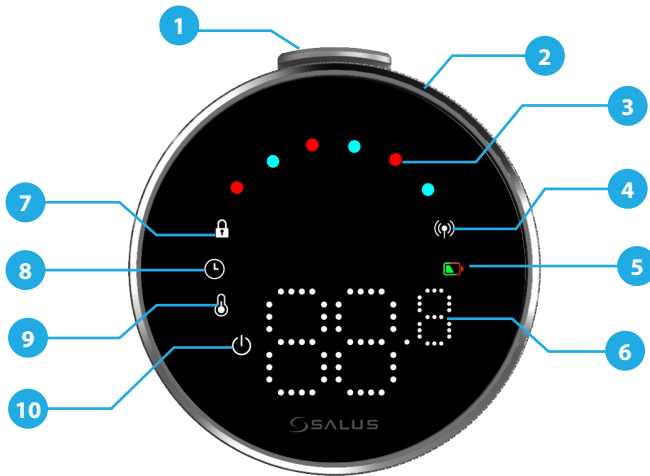

1. Push button
2. Rotating dial
3. Heat/Cool Mode indicator
4. RF status
5. Battery status

6. Temperature display
7. Locked mode
8. Schedule settings
9. Mode setting/Optimum features
10. Frost protection (Off mode)

COMPATIBILITY WITH OTHER SALUS CONTROLS DEVICES

The Elypso Thermostat can work in ONLINE or OFFLINE mode.

At first you need to decide in which mode your thermostat will work.

ONLINE MODE

Universal Gateway is **CONNECTED TO THE INTERNET**. You can configure and use all your devices with the Salus Premium Lite App.



OR



UG600/UGE600

UG800

Download the Salus Premium Lite App on your iOS or Android device for remote access to your Salus equipment.



OFFLINE MODE

Universal Gateway is **NOT CONNECTED TO THE INTERNET**. You can use it with TRV3RF and RX30RF locally (use Pairing menu to pair with them) without the Salus Premium Lite app.



OR



UG600/UGE600

UG800

Compatible devices:



SR600*
Smart Relay



TRV
(Thermostatic Radiator Valve)
with wireless communication



SPE600*
Smart Plug



RX10RF
receiver



UG800
Gateway



UG600/UGE600
Gateway



TRV3RF
Super quiet TRV
(Thermostatic Radiator Valve)
with wireless communication



RX30RF
receiver



KL08RF
Wiring Centre for 8-zone
underfloor heating (UFH)

Power up sequence

Please note:

For an easier installation, please make sure you have already added other devices to your ZigBee network, such as **Underfloor Heating Control Box (KL08RF)** or **Radiator heads (TRV's)** etc.

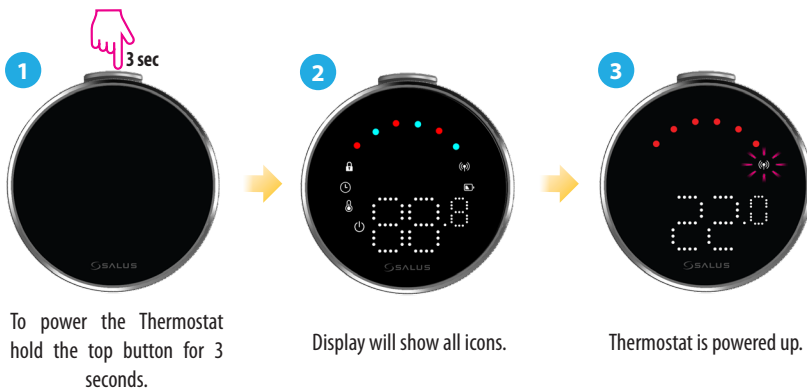

Installation in ONLINE mode

In order to proceed with the installation in online mode, the bellow steps must be followed:



1

This product must be used with the SALUS Premium Lite application on mobile or web by accessing the following link: eu.premium.salusconnect.io or by scanning the QR code:



2



Make sure that the thermostat is powered up and RF signal indicator  is blinking 

3



Press the three-line icon on the top right corner.

4

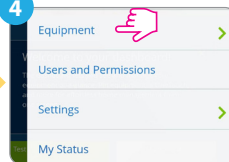

Select **Equipment**.

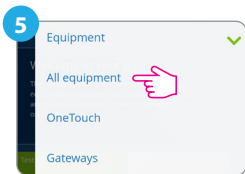

From the drop-down menu, select **All equipment**.

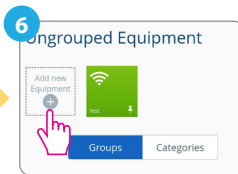

From the **Groups** tab, select **Add new equipment**.

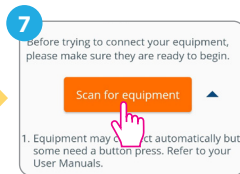

Scan for equipment.

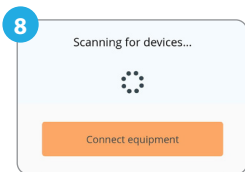

The app will scan for devices.

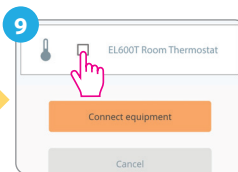

Tick the box to select **EL600T Room Thermostat**.

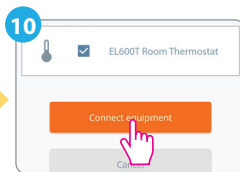

Connect equipment.

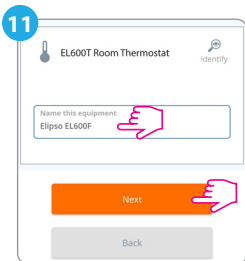

Name your equipment.

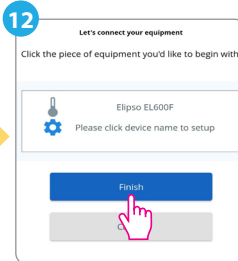

Select **Finish** to get back to the dashboard view.

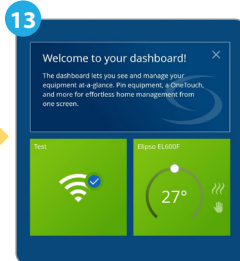





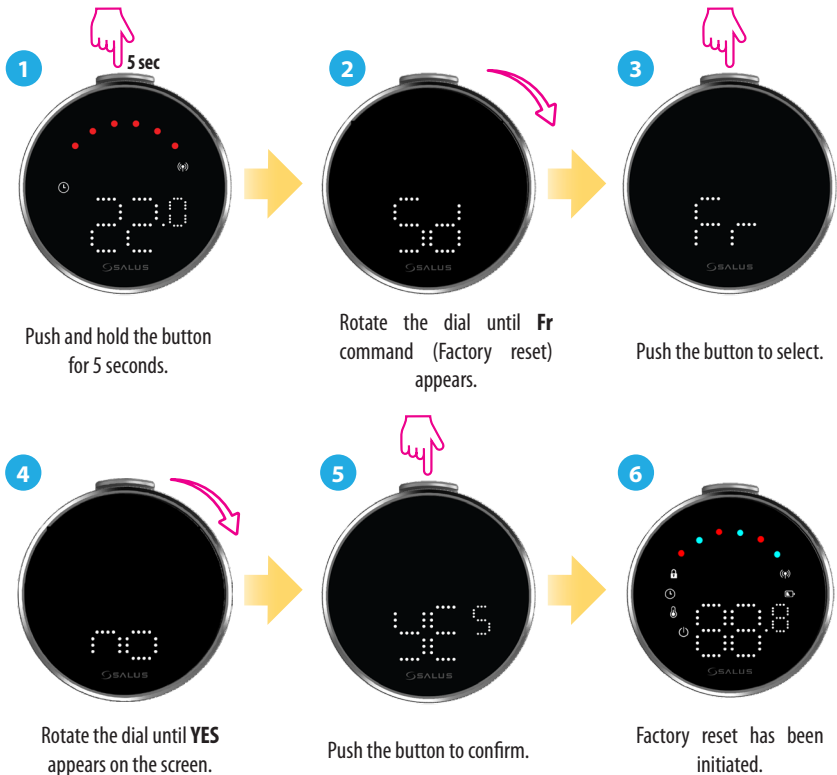

Thermostat has been added to dashboard.

Factory Reset



Thermostat Commands & Functions

Command	Function
	Auto Mode (AU): Automatically adjusts the temperature based on pre-set schedules or sensor readings to maintain the desired comfort.
	Manual Mode (M): Allows you to manually set and control the temperature without automatic adjustments, giving you full control until you choose to change it.
	OFF: Turns off the heating and cooling functions of the thermostat while keeping the device powered on.
	Shut down (Sd): Puts the thermostat into a low-power state, turning off active heating function and minimizing energy consumption.
	Factory reset (Fr): Restores the thermostat to its original factory settings, erasing all custom configurations, schedules, and paired device connections.
	Radio Frequency Indicator (rF): Shows the strength of the RF connection.
	Pairing mode (P): Thermostat activates the pairing mode.

HEAD OFFICE

SALUS Controls
Units 8-10, Northfield Business
Park, Forge Way,
Parkgate, Rotherham,
S60 1SD, United Kingdom

SALUS Controls GmbH,
Dieselstrasse 34,
63165 Mühlheim am Main,
Germany

Email: sales@salus-tech.com



www.saluscontrols.com

SALUS Controls is a member of the Computime Group
Maintaining a policy of continuous product development SALUS Controls plc
reserves the right to change specifications, design and materials of products listed in
this brochure without prior notice.

V02
11/2024

